

AK100/..DS-5.0-H-GREY



Technical Data

Wire Sizes		Insulating Material	
Solid min	0.2 mm ²	Material	PA 6.6
solid max	4.0 mm ²	Flammability Class	UL 94 V-0
Stranded (flexible)		Temperatures	
min	0.2 mm ²	Operating Temperature	-30 °C - 105 °C
Stranded (flexible)		Wave Soldering Process	
max	2.5 mm ²	Soldering Temperature, recommended	265 °C
Stranded with Ferrule		Peak Soldering Time, recommended	3-4 s
min	0.2 mm ²	Reflow Process	
Stranded with Ferrule		Soldering Temperature, recommended	-
max	2.5 mm ²	Peak Soldering Time, recommended	-
Dimensions			
Stripped Length	6.0 mm		
PCB Hole Diameter	1.3 mm		
Materials			
Clamp	Brass		
Wire Guard	Stainless Steel		
Screw	Steel		

Colours

	GREY, RAL7016
	BLUE, RAL5015

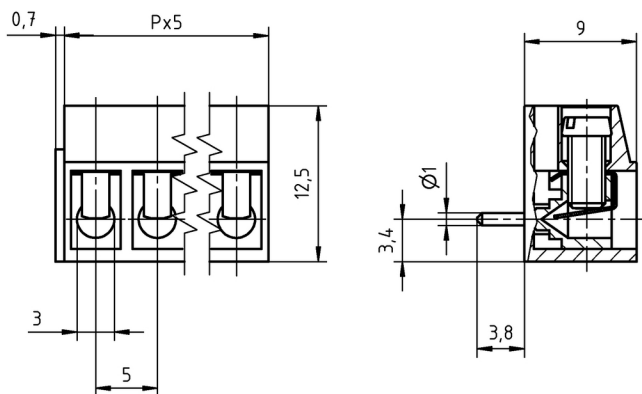

Colours according to RAL, there may be variations on colour due to production conditions. Special colours on request.



Order Data (Spacing 5.0 mm)

Poles	Width (mm)	Article Designation	Article Number	PU
2	10.70	AK100/2DS-5.0-H-GREY	50100020150G	250
3	15.70	AK100/3DS-5.0-H-GREY	50100030150G	250
4	20.70	AK100/4DS-5.0-H-GREY	50100040150G	250
5	25.70	AK100/5DS-5.0-H-GREY	50100050150G	250
6	30.70	AK100/6DS-5.0-H-GREY	50100060150F	200
7	35.70	AK100/7DS-5.0-H-GREY	50100070150F	200
8	40.70	AK100/8DS-5.0-H-GREY	50100080150E	100
9	45.70	AK100/9DS-5.0-H-GREY	50100090150E	100
10	50.70	AK100/10DS-5.0-H-GREY	50100100150E	100
11	55.70	AK100/11DS-5.0-H-GREY	50100110150E	100
12	60.70	AK100/12DS-5.0-H-GREY	50100120150E	100

Accessories

Figure	Designation	Article Number
	Bridge, 2-pole, insulated, BRI/2-5.0/5.08-LIGHT GREY	50000000006
	Bridge, 3-pole, insulated, BRI/3-5.0/5.08-LIGHT GREY	50000000007
	Bridge, 2-pole, BR/2-5.0/5.08-L7.0	50000000008

Ratings



Usegroup	B	C	D		
Rated Voltage	300 V	-	300 V	250 V	
Rated Current	20 A	-	10 A	24 A	
Rated Wire Size			min		max
	solid	AWG 22-12	-	AWG 22-12	0.5 mm ² 2.5 mm ²
	stranded	AWG 22-12	-	AWG 22-12	0.5 mm ² 2.5 mm ²
Torque	0.45 Nm		0.45 Nm		0.50 Nm
Screw Size	M3		M3		M3
Test Voltage	1.6 kV		1.6 kV		2.0 kV