

ONE UNIT MODULAR HOUSING (MM 17.5) H 68 MM.
 FOR MOUNTING ON OMEGA RAIL ACC. TO DIN EN 50022.
 IT IS SUITABLE TO HOUSE ANALOGUE AND DIGITAL
 INSTRUMENTATION. SCREWED OR SNAP-IN LOCKING BETWEEN
 BASE AND COVER. SUITABLE TO HOUSE FIXED OR DETACHABLE
 TERMINALS OF ANY MOUNTING STEP.
 CUSTOM DRILLING ON ANY SIDE (WINDOWS, HOLES, SLOTS).
 MADE OF ~~NYLON~~ **ABS** CLASS V2 OR, ON REQUEST, CLASS V0 (UL 94)
 IN RAL (7035) GREY.

ABS

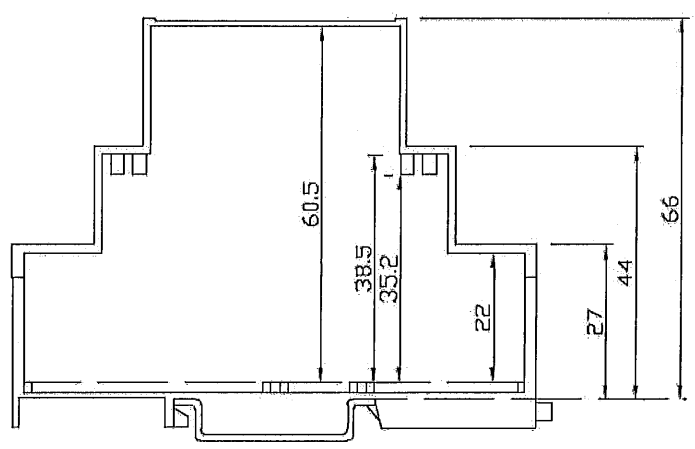
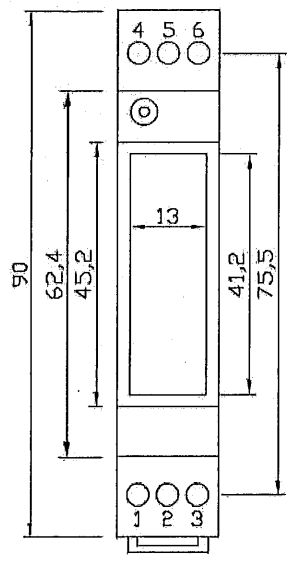
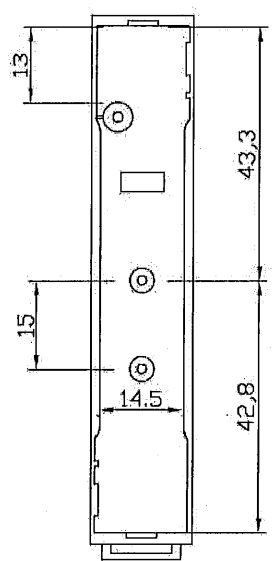
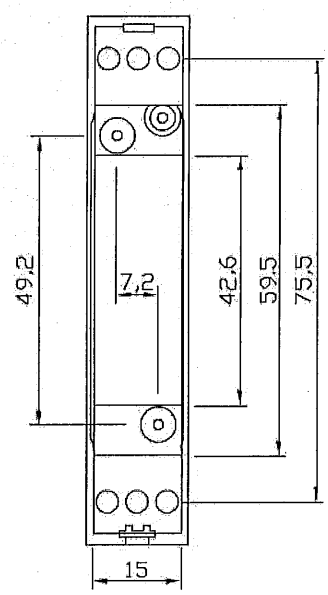
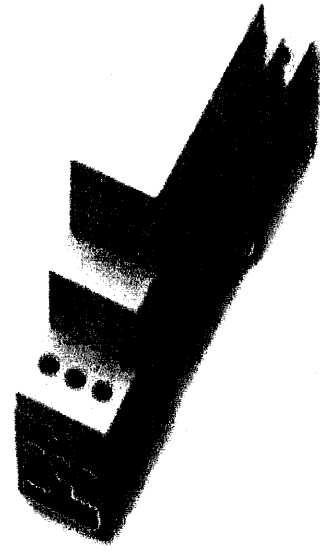

BARRA DIN