



# Elektrotechnik Karl-Heinz Mauz GmbH

**GM15-N20VA-08220-100-10D** (Artikel-Nr. 860513)

**EKULIT**

## *SPECIFICATIONS:*

Item	Unit	Specification
Rated voltage	VDC	6.0
Gear Ratio		1/100
Rotation		CW
Motor Position		All position in horizontal
Temperature	°C	0~30
Humidity	%	30~95
<b>• Performance of Motor</b>		
No-load Speed	rpm	16.500±10%
No-load Current	mA	35 (max.)
Stall Current	mA	650 (max.)
Stall Torque	g.cm	10
<b>• Performance of Gear motor</b>		
Output Speed	rpm	160±10%
No-load Current	mA	40 (max.)
Stall Current	mA	650 (max.)
Stall Torque	kg.cm	1.5
Rated Torque	g.cm	400
Rated Current	mA	150 (max.)
Noise	dB	48
<b>• The Dimension</b>		
The Outside Shaft Length	mm	9.0
Shaft End Play	mm	0.05-0.30
Screw Size		M1.6*0.35
Dia of Shaft	mm	Ø3.0*2.5mm

Adresse: Felix-Wankel-Str. 35 • 73760 Ostfildern/Nellingen

Tel: +49-711/3414023

Fax: +49-711/3414024

E-mail: [info@ekulit.de](mailto:info@ekulit.de) Web site: [www.EKULIT.de](http://www.EKULIT.de)

# Elektrotechnik Karl-Heinz Mauz GmbH

**GM15-N20VA-08220-100-10D** (Artikel-Nr. 860513)

**EKULIT**

**DIMENSIONS :**

(Unit: mm)

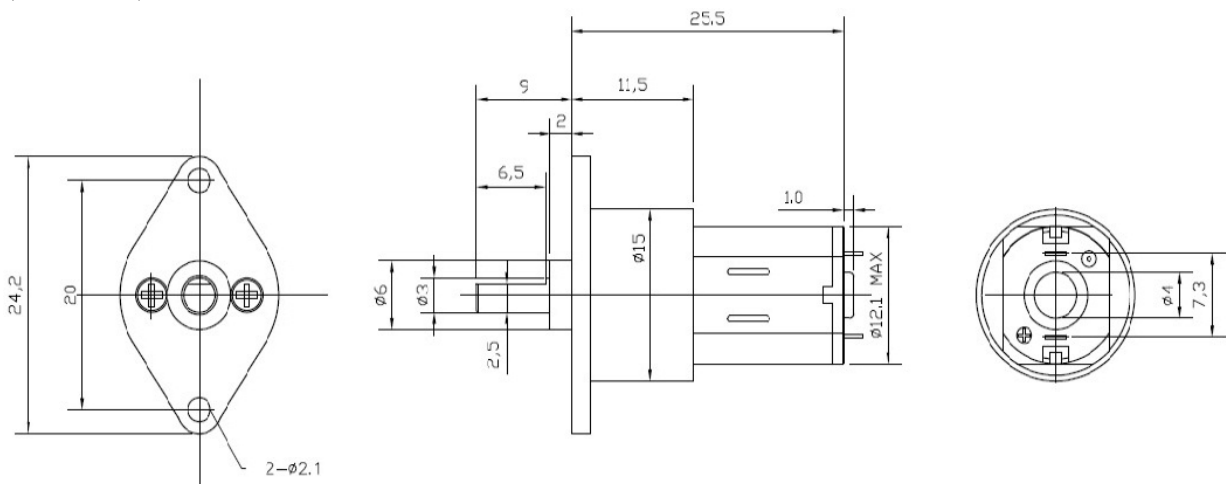

**Curve drawings:**

