

motor with gear
motorreductor

Reference number Referencia	Nominal voltage Tension nominal	Nominal torque Par nominal	Nominal speed Velocidad nominal	Nominal current Corriente nominal	Starting torque Par de arranque	Starting current Corriente de Arranque	Shaft Eje	Connections Conexiones	Wiring diag. Esq. elect.	Transmission ratio Relacion de reduccion	Approximate weight Peso aproximado	Watertightness Grado de estanqueidad	Wheel material Material rueda	Curve Curva
	Un (V)	Mn (N.m./Lbf.in)	nn (r.p.m.)	In (A)	Ma (N.m./Lbf.in)	Ia (A)				i	P (kg / Lb.t)	IP		
316.2711.20.00	12	2 / 17.70	38	3.4	10 / 88.5	12	E29	C30	EE4	62:1	0.90 / 2.41	IP40	PLA	56
316.2711.30.00	24	2 / 17.70	38	1.7	10 / 88.5	6	E29	C30	EE4	62:1	0.90 / 2.41	IP40	PLA	56
316.2761.20.00	12	2 / 17.70	38	3.4	10 / 88.5	12	E30	C30	EE4	62:1	0.90 / 2.41	IP40	PLA	56
316.2761.30.00	24	2 / 17.70	38	1.7	10 / 88.5	6	E30	C30	EE4	62:1	0.90 / 2.41	IP40	PLA	56
316.2761.20.00E	12	2 / 17.70	38	3.4	10 / 88.5	12	E30	C30	F4	62:1	0.90 / 2.41	IP40	PLA	56
316.2761.30.00E	24	2 / 17.70	38	1.7	10 / 88.5	6	E30	C30	F4	62:1	0.90 / 2.41	IP40	PLA	56
316.9728.30.00	24	2 / 17.70	38	1.7	10 / 88.5	6	E30	C30	EE4	62:1	0.90 / 2.41	IP40	BRO	56
316.9731.20.00 *	12	1.5 / 13.27	65	6.0	10 / 88.5	22	E30	C30	EE4	62:1	0.90 / 2.41	IP40	PLA	57
316.9731.30.00 *	24	1.5 / 13.27	65	3.0	10 / 88.5	11	E30	C30	EE4	62:1	0.90 / 2.41	IP40	PLA	57

* (VDE 0530) S3 - 10% (10 min.)

DOGA can develop for you
on this series a customised version:
DOGA puede desarrollar para usted
una versión a medida:

- ▼
- SELF-LOCKING / AUTO-BLOQUEO**
- BRONZE WHEEL / RUEDA DE BRONCE**
- RESINBONDED WHEEL / RUEDA DE CELOTEX**
- FRONT & REAR SHAFT / EJE DELANTERO Y POSTERIOR**
- HALL SENSOR / SENSOR HALL**
- ▲

and many more / y mucho más
please contact us / por favor contactenos

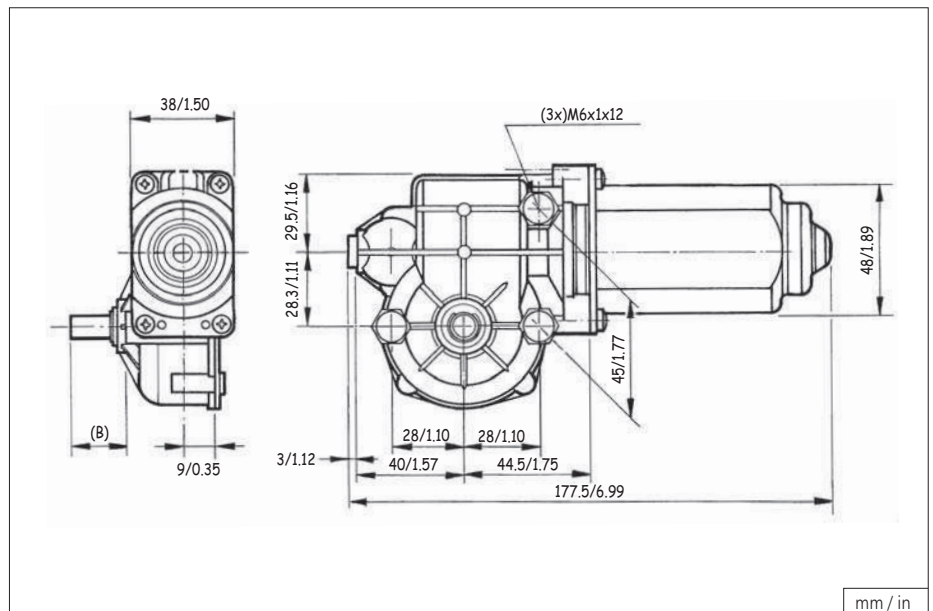

mm / in

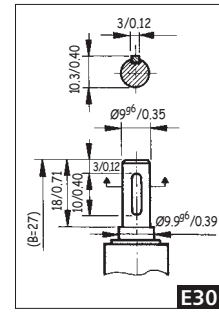
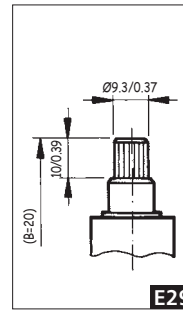

111

CONNECTION - CONEXIÓN

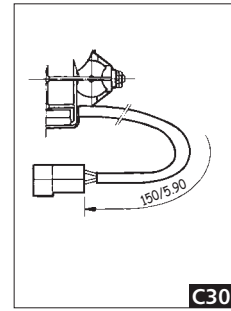

119

210

258

WIRING DIAGRAM - ESQUEMA ELÉCTRICO

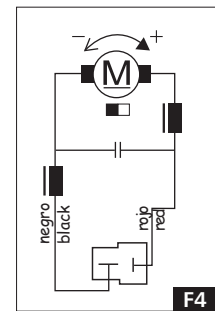
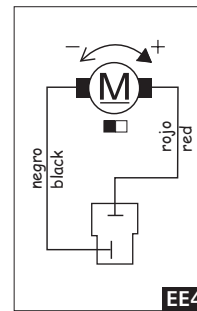

259

316

319

CURVES - CURVAS

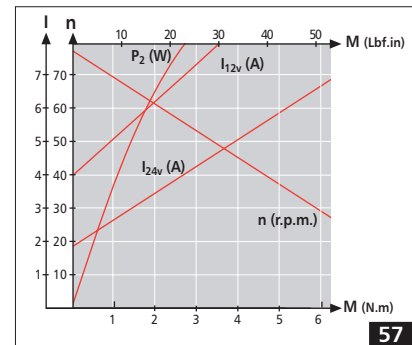
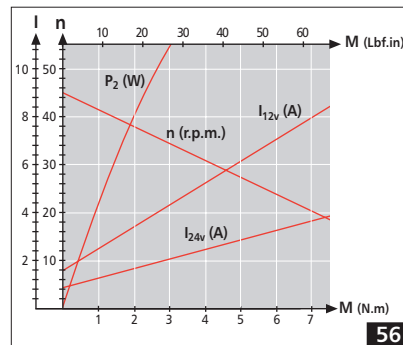

162

168

169

260

269