

# Flat Tabs

**F1275** = Product group; Product group discount F 12 7\_

## Flat Tabs

For Soldering or Screwing

Width: 4,8mm

Surface: Silver and Tin-plated

Series: LS15\_

| Part Nr. | Part description            |
|----------|-----------------------------|
| LS1560   | Flat Tab 4,8x0,8mm 6,5x12,8 |
| LS1560Z  | Flat Tab 4,8x0,8mm 6,3x12,5 |
| LS1537   | Flat Tab 4,8x0,8mm 10x13,5  |
| LS1537Z  | Flat Tab 4,8x0,8mm 10x13,3  |

## Features

- Flat tabs to screw on or solder onto a PCB
- Made of brass, silver plated, LS\_Z tin-plated

## Dimensions

| Part Nr. | b <sub>1</sub> | b <sub>2</sub> | l <sub>1</sub> | l <sub>2</sub> | l <sub>3</sub> | a    | s    |
|----------|----------------|----------------|----------------|----------------|----------------|------|------|
|          | [mm]           | [mm]           | [mm]           | [mm]           | [mm]           | [mm] | [mm] |
| LS1560   | 6,5            | 1,3            | 12,8           | 4,0            | 7,0            | 5,2  | 0,8  |
| LS1560Z  | 6,3            | 1,3            | 12,5           | 4,0            | 6,4            | 5,0  | 0,8  |
| LS1537   | 10,0           | 1,2            | 13,5           | 3,0            | 7,2            | 5,0  | 0,8  |
| LS1537Z  | 10,0           | 1,2            | 13,3           | 3,0            | 7,1            | 5,0  | 0,8  |

s = Material Strength

## Terms of Delivery

Minimum order quantity: 1 PKU = 1000 pieces

Manufacturer: Various

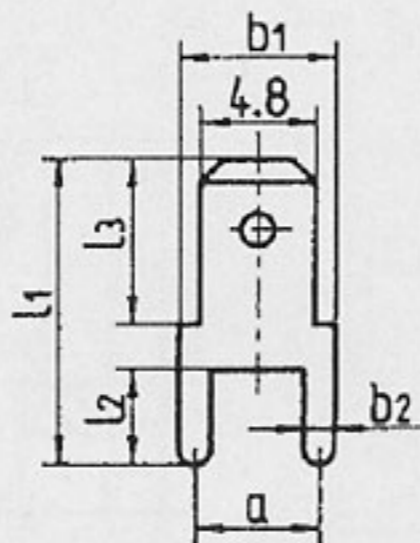

LS1560\_

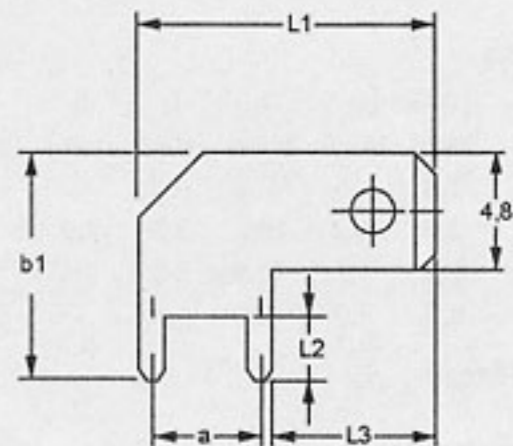

LS1537\_