

# 4-CONDUCTOR DEVICE CONNECTORS FOR FIXING SCREW AND NUT 3 MM Ø OR FOR SELF TAPPING SREW 2.9 MM Ø FROM TOP

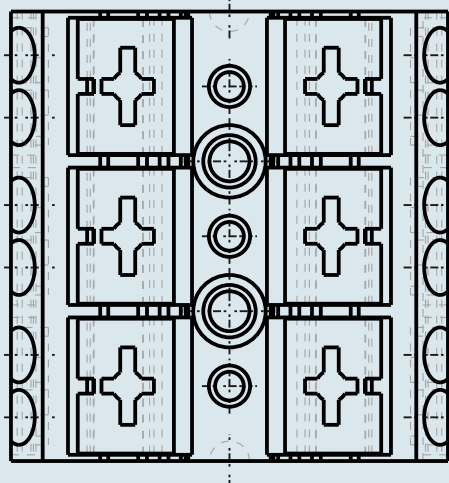
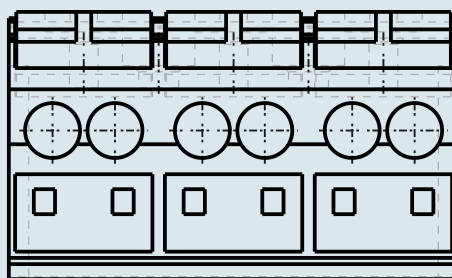
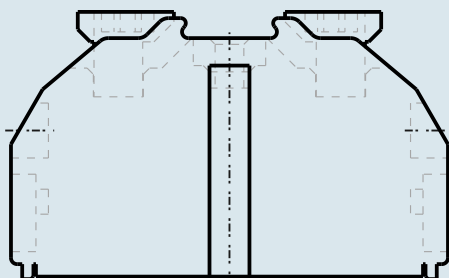
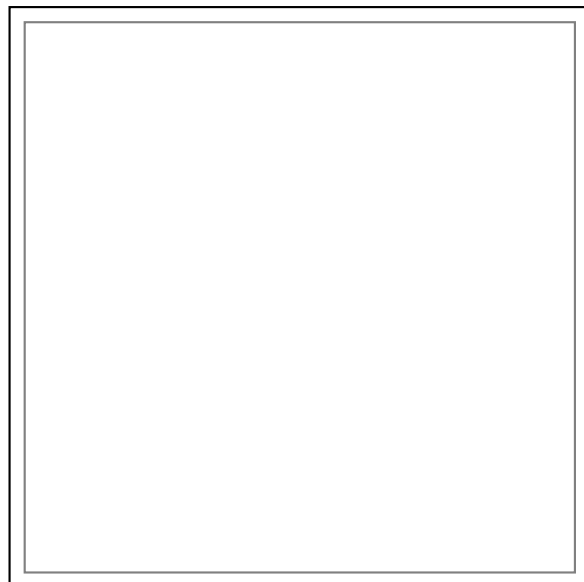
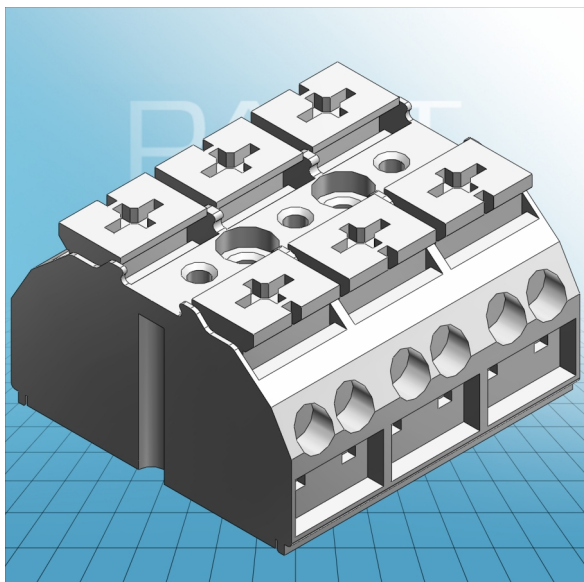

**4-CONDUCTOR DEVICE  
CONNECTORS FOR FIXING SCREW  
AND NUT 3 MM Ø OR FOR SELF  
TAPPING SREW 2.9 MM Ø FROM TOP  
3 POLE  
862-503 TO 862-2603**

ITEM-NO. (ITEM-NO.)	862-2603
Cross section1 (Cross section / mm <sup>2</sup> )	0.5 - 4
Cross section2 (Cross section / AWG)	20 - 12
Strip length (Strip length / mm)	10 - 11
Measured voltage (Measured voltage / V)	500
Measured shock voltage (Measured shock voltage / kV)	6
Pollution degree (Pollution degree)	3
Current intensity (Current intensity / A)	32
P (NO. OF POLES)	3
Height (Height / mm)	21.4
Width (Width / mm)	36
Depth (Depth / mm)	35
No. of connection Points (No. of connection Points)	12
No. of potentials (No. of potentials)	3
COLOR (COLOR)	weiß
Comment (Comment)	N-ERDE-L1