

# Protistor® size 32 aR

450 to 690VAC (IEC) / 700VAC (UL)

## SEMICONDUCTOR PROTECTION FUSES

### SQUARE BODY HIGH-SPEED FUSE-LINKS AC PROTECTION



The 690/700V Protistor® fuse-links provide maximum flexibility in equipment design and ultimate protection for today's power conversion equipment. These aR ultra-fast acting square body fuse-links are available in different body sizes, each size having multiple worldwide acceptable mounting styles.

The Protistor® have been engineered to provide state-of-the-art protection for semiconductors: diodes, thyristors and IGBT devices. Fuses are assembled with die-cut elements embedded in solidified sand, which helps control arcing characteristics for a lower  $I^2t$  and high interrupting rating level. All contact surfaces are silver plated and all hardware is non-magnetic.

Each fuse-link can be equipped with a low voltage trip-indicator which can operate a field mountable microswitch.

## TECHNICAL DATA OVERVIEW

|                      |                 |
|----------------------|-----------------|
| Voltage Range AC     | 450 ... 690 VAC |
| Ampere Range (A)     | 315 ... 1800 A  |
| Speed/Characteristic | aR              |
| I.R. AC              | 110 ... 200 kA  |
| Product Size         | 32              |

## FEATURES & BENEFITS

- Multiple body sizes and terminals or blades combination
- aR Class according to IEC 60269-4 and VDE 636-23
- Very low  $I^2t$  for improved semiconductor protection
- Ultra fast acting
- Current limiting
- Superior cycling capability

## APPLICATIONS

- Protection of inverters, motor drives, UPS systems and similar 690V or less equipments.

## STANDARDS

- IEC 60269-4 Compliance
- UL/CSA Recognized E76491
- CCC GB 13539.4



# Protistor® size 32 aR

450 to 690VAC (IEC) / 700VAC (UL)

## PRODUCT RANGE



PC32UD69V800TF

### Size 32 type TTF M10 threaded terminals

| Catalog number             | Item number | Rated voltage AC (IEC) | Rated voltage AC (UL) | Rated current I <sub>n</sub> | Pre-arcing I <sup>2</sup> t | Clearing I <sup>2</sup> t at Rated Voltage | Rated breaking capacity AC | Power dissipation at I <sub>n</sub> | Weight    | Package |
|----------------------------|-------------|------------------------|-----------------------|------------------------------|-----------------------------|--|----------------------------|-------------------------------------|-----------|---------|
| <b>Standard Terminal</b>   |             |                        |                       |                              |                             |  |                            |                                     |           |         |
| PC32UD69V315TF             | M302162     | 690 V                  | 700 V                 | 315 A                        | 5.2 kA <sup>2</sup> s       | 31.8 kA <sup>2</sup> s                     | 200 kA                     | 71 W                                | 0.5463 kg | 3       |
| PC32UD69V350TF             | N302163     | 690 V                  | 700 V                 | 350 A                        | 8.9 kA <sup>2</sup> s       | 53.7 kA <sup>2</sup> s                     | 200 kA                     | 71 W                                | 0.5463 kg | 3       |
| PC32UD69V400TF             | H300065     | 690 V                  | 700 V                 | 400 A                        | 15 kA <sup>2</sup> s        | 90 kA <sup>2</sup> s                       | 200 kA                     | 72 W                                | 0.5463 kg | 3       |
| PC32UD69V450TF             | J300066     | 690 V                  | 700 V                 | 450 A                        | 22 kA <sup>2</sup> s        | 130 kA <sup>2</sup> s                      | 200 kA                     | 77 W                                | 0.5463 kg | 3       |
| PC32UD69V500TF             | K300067     | 690 V                  | 700 V                 | 500 A                        | 28 kA <sup>2</sup> s        | 145 kA <sup>2</sup> s                      | 200 kA                     | 85 W                                | 0.5463 kg | 3       |
| PC32UD69V550TF             | L300068     | 690 V                  | 700 V                 | 550 A                        | 37 kA <sup>2</sup> s        | 215 kA <sup>2</sup> s                      | 200 kA                     | 90 W                                | 0.5463 kg | 3       |
| PC32UD69V630TF             | M300069     | 690 V                  | 700 V                 | 630 A                        | 54 kA <sup>2</sup> s        | 310 kA <sup>2</sup> s                      | 200 kA                     | 95 W                                | 0.5463 kg | 3       |
| PC32UD69V700TF             | N300070     | 690 V                  | 700 V                 | 700 A                        | 76 kA <sup>2</sup> s        | 440 kA <sup>2</sup> s                      | 200 kA                     | 100 W                               | 0.5463 kg | 3       |
| PC32UD69V800TF             | P300071     | 690 V                  | 700 V                 | 800 A                        | 115 kA <sup>2</sup> s       | 660 kA <sup>2</sup> s                      | 200 kA                     | 110 W                               | 0.5406 kg | 3       |
| <b>Reinforced Terminal</b> |             |                        |                       |                              |                             |  |                            |                                     |           |         |
| PC32UD69V900TF             | Q300072     | 690 V                  | 700 V                 | 900 A                        | 165 kA <sup>2</sup> s       | 990 kA <sup>2</sup> s                      | 200 kA                     | 110 W                               | 0.601 kg  | 3       |
| PC32UD69V1000TF            | S300074     | 690 V                  | 700 V                 | 1000 A                       | 230 kA <sup>2</sup> s       | 1380 kA <sup>2</sup> s                     | 200 kA                     | 115 W                               | 0.601 kg  | 3       |
| PC32UD60V1100TF            | M300759     | 600 V                  | 650 V                 | 1100 A                       | 270 kA <sup>2</sup> s       | 1450 kA <sup>2</sup> s                     | 160 kA                     | 140 W                               | 0.601 kg  | 3       |
| PC32UD55V1250TF            | P301060     | 550 V                  | 600 V                 | 1250 A                       | 410 kA <sup>2</sup> s       | 1950 kA <sup>2</sup> s                     | 150 kA                     | 150 W                               | 0.601 kg  | 3       |
| PC32UD50V1400TF            | Q301061     | 500 V                  | 550 V                 | 1400 A                       | 555 kA <sup>2</sup> s       | 2300 kA <sup>2</sup> s                     | 130 kA                     | 160 W                               | 0.601 kg  | 3       |
| PC32UD50V1600TF            | H300893     | 500 V                  | 550 V                 | 1600 A                       | 870 kA <sup>2</sup> s       | 3600 kA <sup>2</sup> s                     | 130 kA                     | 165 W                               | 0.601 kg  | 3       |
| PC32UD45V1800TF            | R301062     | 450 V                  | 500 V                 | 1800 A                       | 1050 kA <sup>2</sup> s      | 3700 kA <sup>2</sup> s                     | 110 kA                     | 195 W                               | 0.601 kg  | 3       |

### Size 32 type TTI 3/8"-16 unified coarse threaded terminals

| Catalog number             | Item number | Rated voltage AC (IEC) | Rated voltage AC (UL) | Rated current I <sub>n</sub> | Pre-arcing I <sup>2</sup> t | Clearing I <sup>2</sup> t at Rated Voltage | Rated breaking capacity AC | Power dissipation at I <sub>n</sub> | Weight    | Package |
|----------------------------|-------------|------------------------|-----------------------|------------------------------|-----------------------------|--|----------------------------|-------------------------------------|-----------|---------|
| <b>Standard Terminal</b>   |             |                        |                       |                              |                             |  |                            |                                     |           |         |
| A070UD32TTI400             | Q300463     | 690 V                  | 700 V                 | 400 A                        | 15 kA <sup>2</sup> s        | 90 kA <sup>2</sup> s                       | 200 kA                     | 72 W                                | 0.6033 kg | 3       |
| A070UD32TTI450             | N300461     | 690 V                  | 700 V                 | 450 A                        | 22 kA <sup>2</sup> s        | 130 kA <sup>2</sup> s                      | 200 kA                     | 77 W                                | 0.6033 kg | 3       |
| A070UD32TTI500             | P300462     | 690 V                  | 700 V                 | 500 A                        | 28 kA <sup>2</sup> s        | 160 kA <sup>2</sup> s                      | 200 kA                     | 85 W                                | 0.6033 kg | 3       |
| A070UD32TTI550             | R300464     | 690 V                  | 700 V                 | 550 A                        | 37 kA <sup>2</sup> s        | 215 kA <sup>2</sup> s                      | 200 kA                     | 90 W                                | 0.6033 kg | 3       |
| A070UD32TTI630             | S300465     | 690 V                  | 700 V                 | 630 A                        | 54 kA <sup>2</sup> s        | 310 kA <sup>2</sup> s                      | 200 kA                     | 95 W                                | 0.6033 kg | 3       |
| A070UD32TTI700             | T300466     | 690 V                  | 700 V                 | 700 A                        | 76 kA <sup>2</sup> s        | 440 kA <sup>2</sup> s                      | 200 kA                     | 100 W                               | 0.6033 kg | 3       |
| A070UD32TTI800             | V300467     | 690 V                  | 700 V                 | 800 A                        | 115 kA <sup>2</sup> s       | 660 kA <sup>2</sup> s                      | 200 kA                     | 110 W                               | 0.6033 kg | 3       |
| <b>Reinforced Terminal</b> |             |                        |                       |                              |                             |  |                            |                                     |           |         |
| A070UD32TTI900             | W300468     | 690 V                  | 700 V                 | 900 A                        | 165 kA <sup>2</sup> s       | 990 kA <sup>2</sup> s                      | 200 kA                     | 110 W                               | 0.6 kg    | 3       |
| A070UD32TTI1000            | X300469     | 690 V                  | 700 V                 | 1000 A                       | 230 kA <sup>2</sup> s       | 1380 kA <sup>2</sup> s                     | 200 kA                     | 115 W                               | 0.6033 kg | 3       |
| A065UD32TTI1100            | M301081     | 600 V                  | 650 V                 | 1100 A                       | 270 kA <sup>2</sup> s       | 1450 kA <sup>2</sup> s                     | 160 kA                     | 140 W                               | 0.6 kg    | 3       |
| A060UD32TTI1250            | N301082     | 550 V                  | 600 V                 | 1250 A                       | 410 kA <sup>2</sup> s       | 1950 kA <sup>2</sup> s                     | 150 kA                     | 150 W                               | 0.6 kg    | 3       |
| A055UD32TTI1400            | P301083     | 500 V                  | 550 V                 | 1400 A                       | 555 kA <sup>2</sup> s       | 2300 kA <sup>2</sup> s                     | 130 kA                     | 160 W                               | 0.6033 kg | 3       |
| A055UD32TTI1600            | Q301084     | 500 V                  | 550 V                 | 1600 A                       | 870 kA <sup>2</sup> s       | 3600 kA <sup>2</sup> s                     | 130 kA                     | 165 W                               | 0.6 kg    | 3       |
| A050UD32TTI1800            | R301085     | 450 V                  | 500 V                 | 1800 A                       | 1050 kA <sup>2</sup> s      | 3700 kA <sup>2</sup> s                     | 110 kA                     | 195 W                               | 0.6 kg    | 3       |

MERSEN reserves the right to change, update or correct, without notice, any information contained in this datasheet.

# Protistor® size 32 aR

450 to 690VAC (IEC) / 700VAC (UL)

## PRODUCT RANGE

### Size 32 type DIN80 blades

| Catalog number | Item number | Rated voltage AC (IEC) | Rated voltage AC (UL) | Rated current I <sub>n</sub> | Pre-arcing I <sup>2</sup> t | Clearing I <sup>2</sup> t at Rated Voltage | Rated breaking capacity AC | Power dissipation at I <sub>n</sub> | Weight    | Package |
|----------------|-------------|------------------------|-----------------------|------------------------------|-----------------------------|--|----------------------------|-------------------------------------|-----------|---------|
| PC32UD69V315A  | H302158     | 690 V                  | 700 V                 | 315 A                        | 5.2 kA <sup>2</sup> s       | 31.8 kA <sup>2</sup> s                     | 200 kA                     | 71 W                                | 530 g     | 3       |
| PC32UD69V350A  | J302159     | 690 V                  | 700 V                 | 350 A                        | 8.9 kA <sup>2</sup> s       | 53.7 kA <sup>2</sup> s                     | 200 kA                     | 74 W                                | 530 g     | 3       |
| PC32UD69V400A  | E300177     | 690 V                  | 700 V                 | 400 A                        | 15 kA <sup>2</sup> s        | 90 kA <sup>2</sup> s                       | 200 kA                     | 75 W                                | 0.5293 kg | 3       |
| PC32UD69V450A  | F300178     | 690 V                  | 700 V                 | 450 A                        | 22 kA <sup>2</sup> s        | 130 kA <sup>2</sup> s                      | 200 kA                     | 80 W                                | 0.5293 kg | 3       |
| PC32UD69V500A  | G300179     | 690 V                  | 700 V                 | 500 A                        | 28 kA <sup>2</sup> s        | 160 kA <sup>2</sup> s                      | 200 kA                     | 90 W                                | 0.5293 kg | 3       |
| PC32UD69V550A  | H300180     | 690 V                  | 700 V                 | 550 A                        | 37 A <sup>2</sup> s         | 215 kA <sup>2</sup> s                      | 200 kA                     | 95 W                                | 0.5293 kg | 3       |
| PC32UD69V630A  | J300181     | 690 V                  | 700 V                 | 630 A                        | 54 kA <sup>2</sup> s        | 310 kA <sup>2</sup> s                      | 200 kA                     | 105 W                               | 0.5293 kg | 3       |
| PC32UD69V700A  | K300182     | 690 V                  | 700 V                 | 700 A                        | 76 A <sup>2</sup> s         | 440 kA <sup>2</sup> s                      | 200 kA                     | 110 W                               | 0.5293 kg | 3       |
| PC32UD69V800A  | L300183     | 690 V                  | 700 V                 | 800 A                        | 115 kA <sup>2</sup> s       | 660 kA <sup>2</sup> s                      | 200 kA                     | 120 W                               | 0.5293 kg | 3       |
| PC32UD69V900A  | M300184     | 690 V                  | 700 V                 | 900 A                        | 170 kA <sup>2</sup> s       | 990 kA <sup>2</sup> s                      | 200 kA                     | 125 W                               | 0.5293 kg | 3       |
| PC32UD69V1000A | N300185     | 690 V                  | 700 V                 | 1000 A                       | 240 kA <sup>2</sup> s       | 1380 kA <sup>2</sup> s                     | 200 kA                     | 135 W                               | 0.5293 kg | 3       |
| PC32UD60V1100A | W302101     | 600 V                  | 650 V                 | 1100 A                       | 270 kA <sup>2</sup> s       | 1450 kA <sup>2</sup> s                     | 160 kA                     | 165 W                               | 0.704 kg  | 3       |
| PC32UD55V1250A | G300409     | 550 V                  | 600 V                 | 1250 A                       | 410 kA <sup>2</sup> s       | 1950 kA <sup>2</sup> s                     | 150 kA                     | 180 W                               | 0.5293 kg | 3       |

### Size 32 type DIN110 blades

| Catalog number  | Item number | Rated voltage AC (IEC) | Rated voltage AC (UL) | Rated current I <sub>n</sub> | Pre-arcing I <sup>2</sup> t | Clearing I <sup>2</sup> t at Rated Voltage | Rated breaking capacity AC | Power dissipation at I <sub>n</sub> | Weight    | Package |
|-----------------|-------------|------------------------|-----------------------|------------------------------|-----------------------------|--|----------------------------|-------------------------------------|-----------|---------|
| PC32UD69V315D1A | K302160     | 690 V                  | 700 V                 | 315 A                        | 5.2 A <sup>2</sup> s        | 31.8 kA <sup>2</sup> s                     | 200 kA                     | 71 W                                | 0.5633 kg | 3       |
| PC32UD69V350D1A | L302161     | 690 V                  | 700 V                 | 350 A                        | 8.9 kA <sup>2</sup> s       | 53.7 kA <sup>2</sup> s                     | 200 kA                     | 74 W                                | 565 g     | 3       |
| PC32UD69V400D1A | P300186     | 690 V                  | 700 V                 | 400 A                        | 15 kA <sup>2</sup> s        | 90 kA <sup>2</sup> s                       | 200 kA                     | 75 W                                | 0.5633 kg | 3       |
| PC32UD69V450D1A | Q300187     | 690 V                  | 700 V                 | 450 A                        | 22 kA <sup>2</sup> s        | 130 kA <sup>2</sup> s                      | 200 kA                     | 80 W                                | 0.5633 kg | 3       |
| PC32UD69V500D1A | R300188     | 690 V                  | 700 V                 | 500 A                        | 28 A <sup>2</sup> s         | 160 kA <sup>2</sup> s                      | 200 kA                     | 90 W                                | 0.5633 kg | 3       |
| PC32UD69V550D1A | S300189     | 690 V                  | 700 V                 | 550 A                        | 37 kA <sup>2</sup> s        | 215 kA <sup>2</sup> s                      | 200 kA                     | 95 W                                | 0.5633 kg | 3       |
| PC32UD69V630D1A | T300190     | 690 V                  | 700 V                 | 630 A                        | 54 kA <sup>2</sup> s        | 310 kA <sup>2</sup> s                      | 200 kA                     | 105 W                               | 0.5633 kg | 3       |
| PC32UD69V700D1A | V300191     | 690 V                  | 700 V                 | 700 A                        | 76 kA <sup>2</sup> s        | 440 kA <sup>2</sup> s                      | 200 kA                     | 110 W                               | 0.5633 kg | 3       |
| PC32UD69V800D1A | W300192     | 690 V                  | 700 V                 | 800 A                        | 115 kA <sup>2</sup> s       | 660 kA <sup>2</sup> s                      | 200 kA                     | 120 W                               | 0.5633 kg | 3       |
| PC32UD69V900D1A | X300193     | 690 V                  | 700 V                 | 900 A                        | 170 kA <sup>2</sup> s       | 990 kA <sup>2</sup> s                      | 200 kA                     | 125 W                               | 0.5633 kg | 3       |
| PC32UD69V10CD1A | Y300194     | 690 V                  | 700 V                 | 1000 A                       | 240 kA <sup>2</sup> s       | 1380 kA <sup>2</sup> s                     | 200 kA                     | 135 W                               | 0.5633 kg | 3       |

### Size 32 type KI short slotted blades

| Catalog number | Item number | Rated voltage AC (IEC) | Rated voltage AC (UL) | Rated current I <sub>n</sub> | Pre-arcing I <sup>2</sup> t | Clearing I <sup>2</sup> t at Rated Voltage | Rated breaking capacity AC | Power dissipation at I <sub>n</sub> | Weight    | Package |
|----------------|-------------|------------------------|-----------------------|------------------------------|-----------------------------|--|----------------------------|-------------------------------------|-----------|---------|
| A070UD32KI315  | P302164     | 690 V                  | 700 V                 | 315 A                        | 5.2 kA <sup>2</sup> s       | 31.8 kA <sup>2</sup> s                     | 200 kA                     | 71 W                                | 0.5523 kg | 3       |
| A070UD32KI350  | Q302165     | 690 V                  | 700 V                 | 350 A                        | 8.9 kA <sup>2</sup> s       | 53.7 kA <sup>2</sup> s                     | 200 kA                     | 74 W                                | 0.5523 kg | 3       |
| A070UD32KI400  | Z300195     | 690 V                  | 700 V                 | 400 A                        | 15 kA <sup>2</sup> s        | 90 kA <sup>2</sup> s                       | 200 kA                     | 75 W                                | 0.5523 kg | 3       |
| A070UD32KI450  | A300196     | 690 V                  | 700 V                 | 450 A                        | 22 kA <sup>2</sup> s        | 130 kA <sup>2</sup> s                      | 200 kA                     | 80 W                                | 0.5523 kg | 3       |
| A070UD32KI500  | B300197     | 690 V                  | 700 V                 | 500 A                        | 28 kA <sup>2</sup> s        | 160 kA <sup>2</sup> s                      | 200 kA                     | 90 W                                | 0.5523 kg | 3       |
| A070UD32KI550  | C300198     | 690 V                  | 700 V                 | 550 A                        | 37 kA <sup>2</sup> s        | 215 kA <sup>2</sup> s                      | 200 kA                     | 95 W                                | 0.5523 kg | 3       |
| A070UD32KI630  | D300199     | 690 V                  | 700 V                 | 630 A                        | 54 kA <sup>2</sup> s        | 310 kA <sup>2</sup> s                      | 200 kA                     | 105 W                               | 0.5523 kg | 3       |
| A070UD32KI700  | E300200     | 690 V                  | 700 V                 | 700 A                        | 76 kA <sup>2</sup> s        | 440 kA <sup>2</sup> s                      | 200 kA                     | 110 W                               | 0.5523 kg | 3       |
| A070UD32KI800  | F300201     | 690 V                  | 700 V                 | 800 A                        | 115 kA <sup>2</sup> s       | 660 kA <sup>2</sup> s                      | 200 kA                     | 120 W                               | 0.5523 kg | 3       |
| A070UD32KI900  | G300202     | 690 V                  | 700 V                 | 900 A                        | 170 kA <sup>2</sup> s       | 990 kA <sup>2</sup> s                      | 200 kA                     | 125 W                               | 0.5523 kg | 3       |
| A070UD32KI1000 | H300203     | 690 V                  | 700 V                 | 1000 A                       | 240 kA <sup>2</sup> s       | 1380 kA <sup>2</sup> s                     | 200 kA                     | 135 W                               | 0.5523 kg | 3       |

# Protistor® size 32 aR

450 to 690VAC (IEC) / 700VAC (UL)

## PRODUCT RANGE

### Size 32 type LI long slotted blades

| Catalog number | Item number | Rated voltage AC (IEC) | Rated voltage AC (UL) | Rated current I <sub>n</sub> | Pre-arcing I <sup>2</sup> t | Clearing I <sup>2</sup> t at Rated Voltage | Rated breaking capacity AC | Power dissipation at I <sub>n</sub> | Weight    | Package |
|----------------|-------------|------------------------|-----------------------|------------------------------|-----------------------------|--|----------------------------|-------------------------------------|-----------|---------|
| A070UD32LI315  | R302166     | 690 V                  | 700 V                 | 315 A                        | 5.2 kA <sup>2</sup> s       | 31.8 kA <sup>2</sup> s                     | 200 kA                     | 71 W                                | 0.5733 kg | 3       |
| A070UD32LI350  | S302167     | 690 V                  | 700 V                 | 350 A                        | 8.9 kA <sup>2</sup> s       | 53.7 kA <sup>2</sup> s                     | 200 kA                     | 74 W                                | 0.5733 kg | 3       |
| A070UD32LI400  | J300204     | 690 V                  | 700 V                 | 400 A                        | 15 kA <sup>2</sup> s        | 90 kA <sup>2</sup> s                       | 200 kA                     | 75 W                                | 0.5733 kg | 3       |
| A070UD32LI450  | K300205     | 690 V                  | 700 V                 | 450 A                        | 22 kA <sup>2</sup> s        | 130 kA <sup>2</sup> s                      | 200 kA                     | 80 W                                | 0.5733 kg | 3       |
| A070UD32LI500  | L300206     | 690 V                  | 700 V                 | 500 A                        | 28 kA <sup>2</sup> s        | 160 kA <sup>2</sup> s                      | 200 kA                     | 90 W                                | 0.5733 kg | 3       |
| A070UD32LI550  | M300207     | 690 V                  | 700 V                 | 550 A                        | 37 kA <sup>2</sup> s        | 215 kA <sup>2</sup> s                      | 200 kA                     | 95 W                                | 0.5733 kg | 3       |
| A070UD32LI630  | N300208     | 690 V                  | 700 V                 | 630 A                        | 54 kA <sup>2</sup> s        | 310 kA <sup>2</sup> s                      | 200 kA                     | 105 W                               | 0.5733 kg | 3       |
| A070UD32LI700  | P300209     | 690 V                  | 700 V                 | 700 A                        | 76 kA <sup>2</sup> s        | 440 kA <sup>2</sup> s                      | 200 kA                     | 110 W                               | 0.5733 kg | 3       |
| A070UD32LI800  | Q300210     | 690 V                  | 700 V                 | 800 A                        | 115 kA <sup>2</sup> s       | 660 kA <sup>2</sup> s                      | 200 kA                     | 120 W                               | 0.5733 kg | 3       |
| A070UD32LI900  | R300211     | 690 V                  | 700 V                 | 900 A                        | 170 kA <sup>2</sup> s       | 990 kA <sup>2</sup> s                      | 200 kA                     | 125 W                               | 0.7433 kg | 3       |
| A070UD32LI1000 | S300212     | 690 V                  | 700 V                 | 1000 A                       | 240 kA <sup>2</sup> s       | 1380 kA <sup>2</sup> s                     | 200 kA                     | 135 W                               | 0.7433 kg | 3       |
| A065UD32LI1100 | B301071     | 600 V                  | 650 V                 | 1100 A                       | 270 kA <sup>2</sup> s       | 1450 kA <sup>2</sup> s                     | 160 kA                     | 165 W                               | 0.7433 kg | 3       |
| A060UD32LI1250 | C301072     | 550 V                  | 600 V                 | 1250 A                       | 410 kA <sup>2</sup> s       | 1950 kA <sup>2</sup> s                     | 150 kA                     | 180 W                               | 0.7433 kg | 3       |
| A070UD32LI1400 | D301073     | 500 V                  | 550 V                 | 1400 A                       | 555 kA <sup>2</sup> s       | 2300 kA <sup>2</sup> s                     | 200 kA                     | 200 W                               | 0.7433 kg | 3       |

### Size 32 type EF blades for bolted connections

| Catalog number  | Item number | Rated voltage AC (IEC) | Rated voltage AC (UL) | Rated current I <sub>n</sub> | Pre-arcing I <sup>2</sup> t | Clearing I <sup>2</sup> t at Rated Voltage | Rated breaking capacity AC | Power dissipation at I <sub>n</sub> | Weight    | Package |
|-----------------|-------------|------------------------|-----------------------|------------------------------|-----------------------------|--|----------------------------|-------------------------------------|-----------|---------|
| PC32UD69V400EF  | V300168     | 690 V                  | 700 V                 | 400 A                        | 15 kA <sup>2</sup> s        | 90 kA <sup>2</sup> s                       | 200 kA                     | 75 W                                | 0.5716 kg | 3       |
| PC32UD69V450EF  | W300169     | 690 V                  | 700 V                 | 450 A                        | 22 kA <sup>2</sup> s        | 130 kA <sup>2</sup> s                      | 200 kA                     | 80 W                                | 0.5716 kg | 3       |
| PC32UD69V500EF  | X300170     | 690 V                  | 700 V                 | 500 A                        | 28 kA <sup>2</sup> s        | 160 kA <sup>2</sup> s                      | 200 kA                     | 90 W                                | 0.5716 kg | 3       |
| PC32UD69V550EF  | Y300171     | 690 V                  | 700 V                 | 550 A                        | 37 kA <sup>2</sup> s        | 215 kA <sup>2</sup> s                      | 200 kA                     | 95 W                                | 0.5716 kg | 3       |
| PC32UD69V630EF  | Z300172     | 690 V                  | 700 V                 | 630 A                        | 54 kA <sup>2</sup> s        | 310 kA <sup>2</sup> s                      | 200 kA                     | 105 W                               | 0.5716 kg | 3       |
| PC32UD69V700EF  | A300173     | 690 V                  | 700 V                 | 700 A                        | 76 kA <sup>2</sup> s        | 440 kA <sup>2</sup> s                      | 200 kA                     | 110 W                               | 0.5716 kg | 3       |
| PC32UD69V800EF  | B300174     | 690 V                  | 700 V                 | 800 A                        | 115 kA <sup>2</sup> s       | 660 kA <sup>2</sup> s                      | 200 kA                     | 120 W                               | 0.5716 kg | 3       |
| PC32UD69V900EF  | C300175     | 690 V                  | 700 V                 | 900 A                        | 170 kA <sup>2</sup> s       | 990 kA <sup>2</sup> s                      | 200 kA                     | 125 W                               | 0.5716 kg | 3       |
| PC32UD69V1000EF | D300176     | 690 V                  | 700 V                 | 1000 A                       | 240 kA <sup>2</sup> s       | 1380 kA <sup>2</sup> s                     | 200 kA                     | 135 W                               | 0.5716 kg | 3       |

MERSEN reserves the right to change, update or correct, without notice, any information contained in this datasheet.

## TIME CURRENT CHARACTERISTIC CURVES

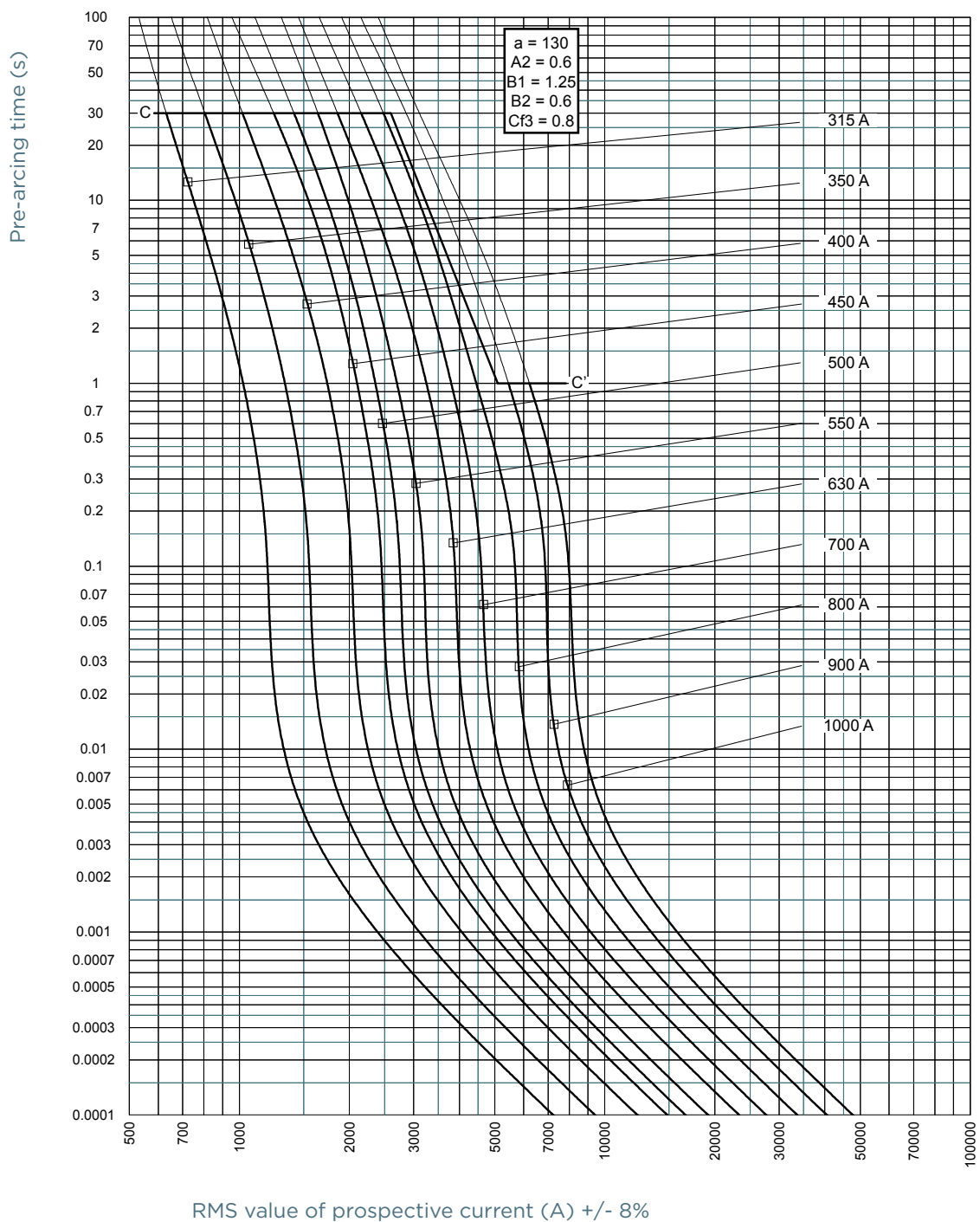

## TIME CURRENT CHARACTERISTIC CURVES

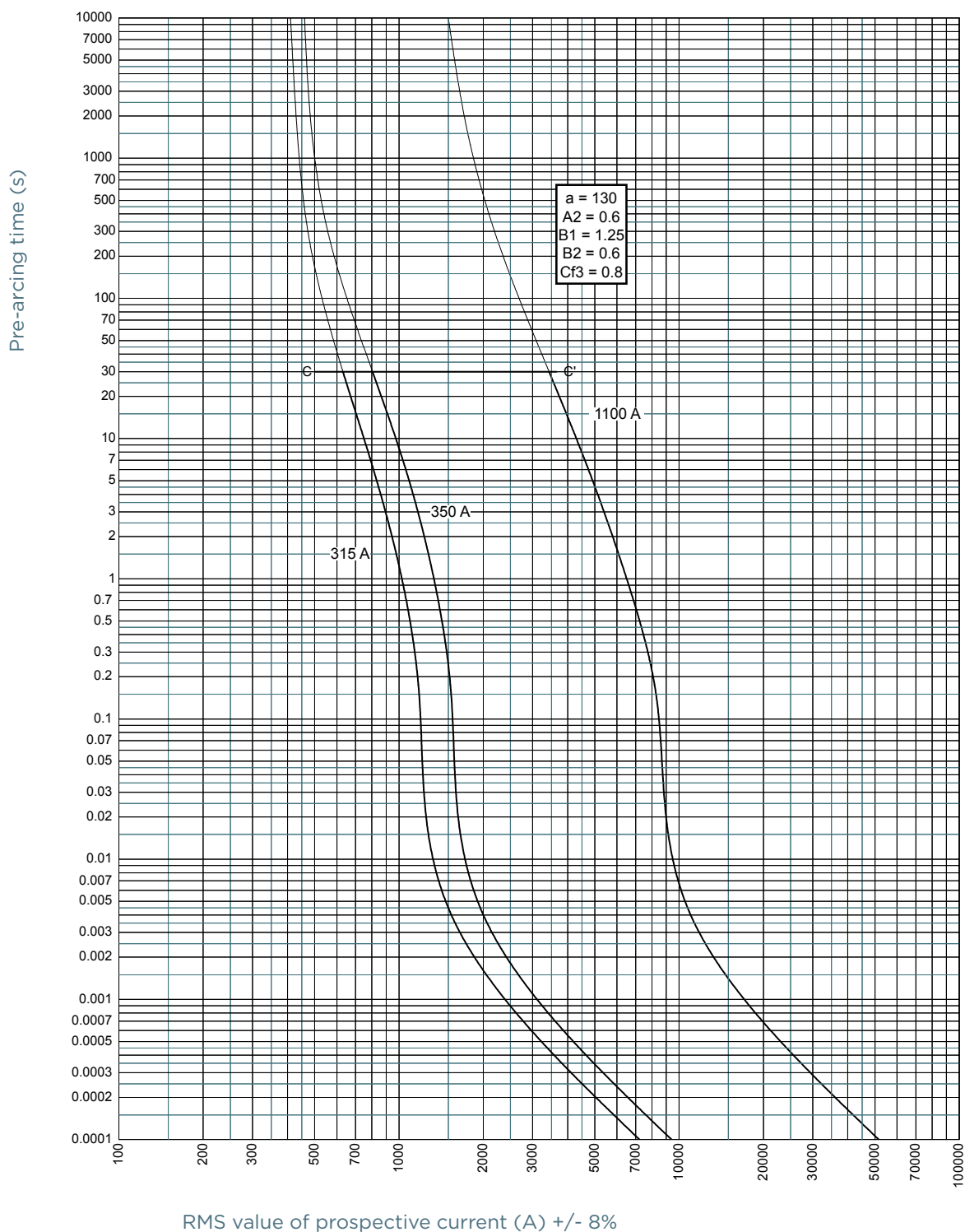

TIME CURRENT CHARACTERISTIC CURVES

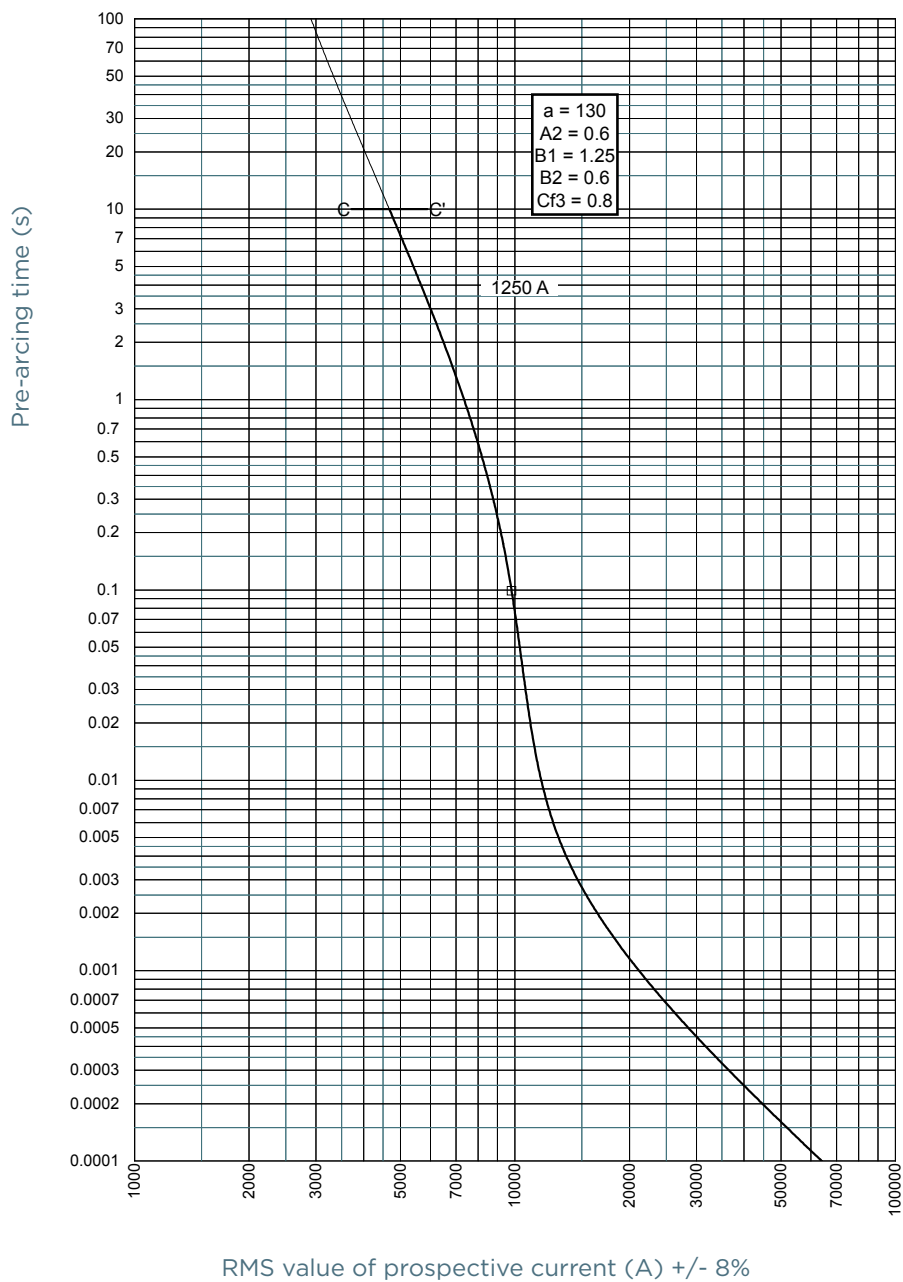

MERSEN reserves the right to change, update or correct, without notice, any information contained in this datasheet.

## TIME CURRENT CHARACTERISTIC CURVES

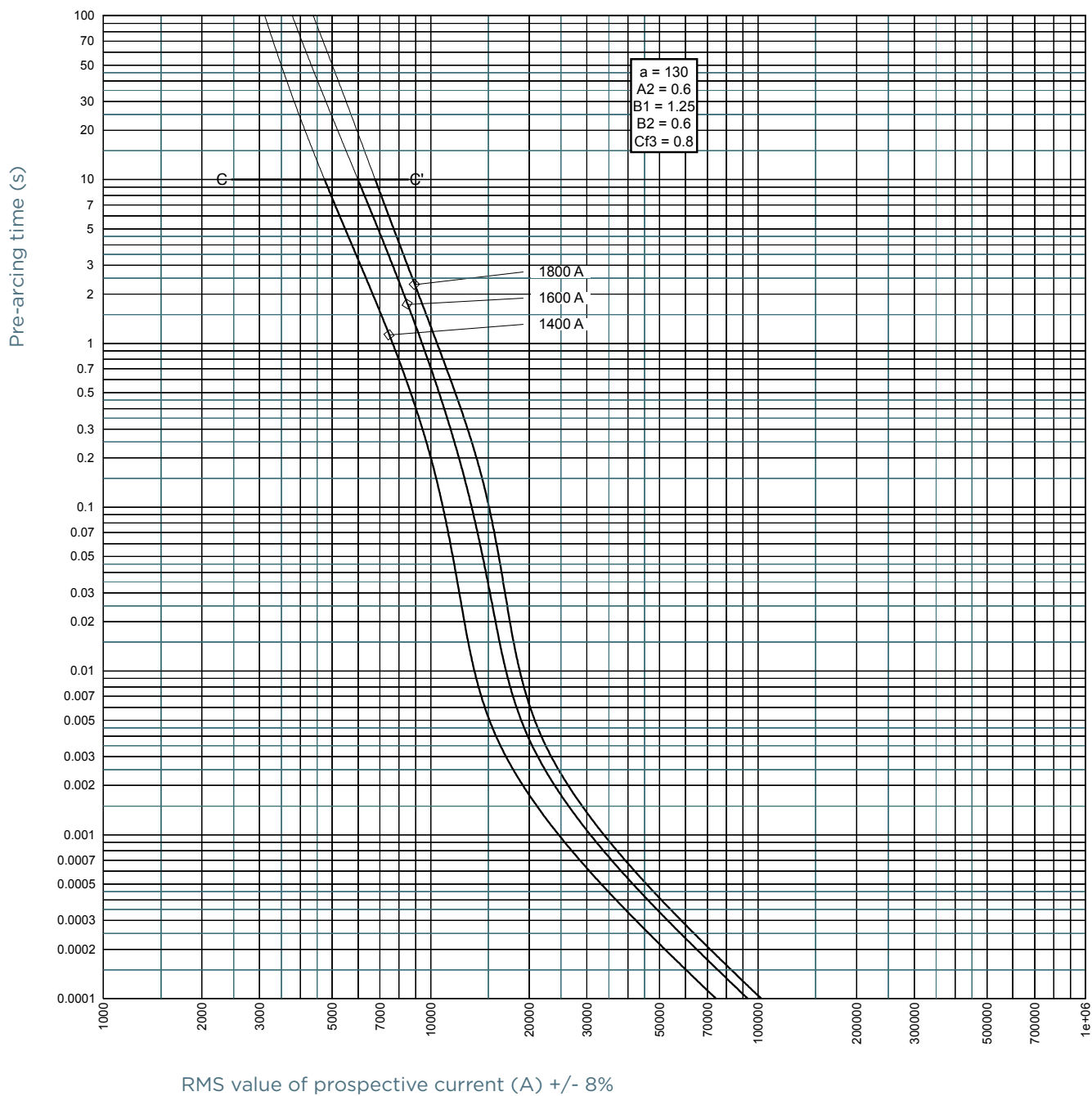



CUT-OFF CURRENT CHARACTERISTIC

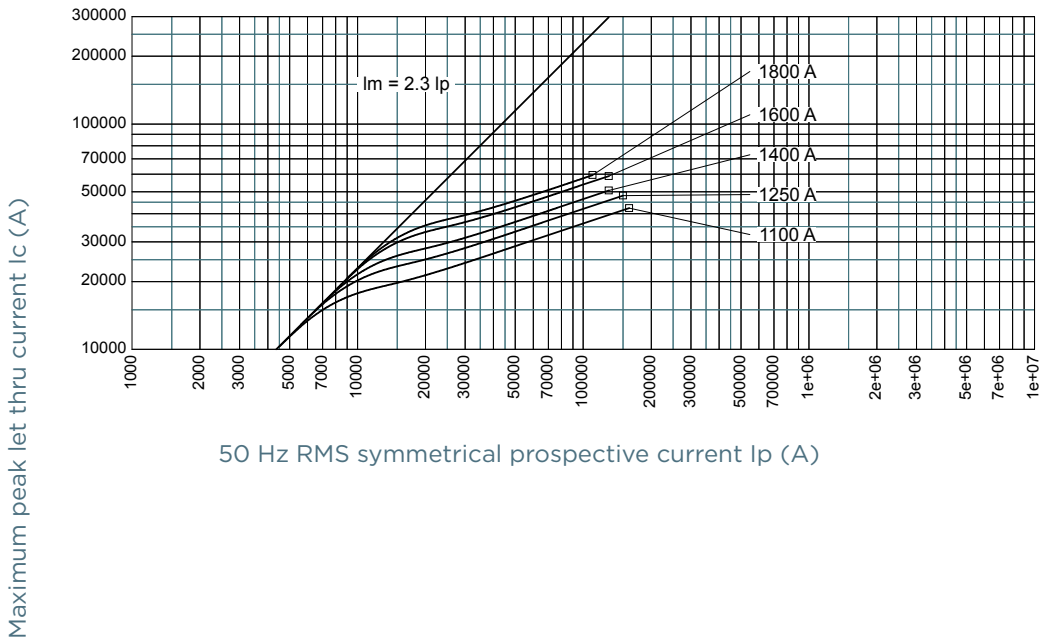
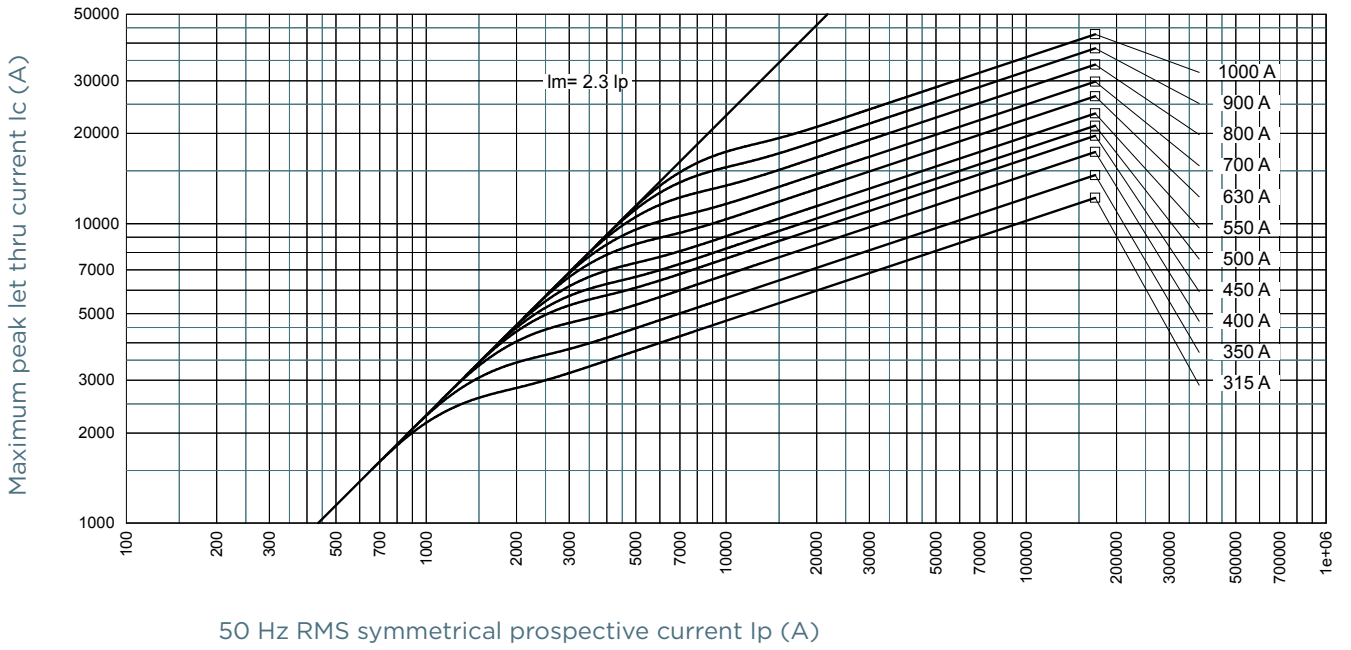

MERSEN reserves the right to change, update or correct, without notice, any information contained in this datasheet.

## I<sup>2</sup>T MULTIPLIER COEFFICIENT

### Size 32 690V

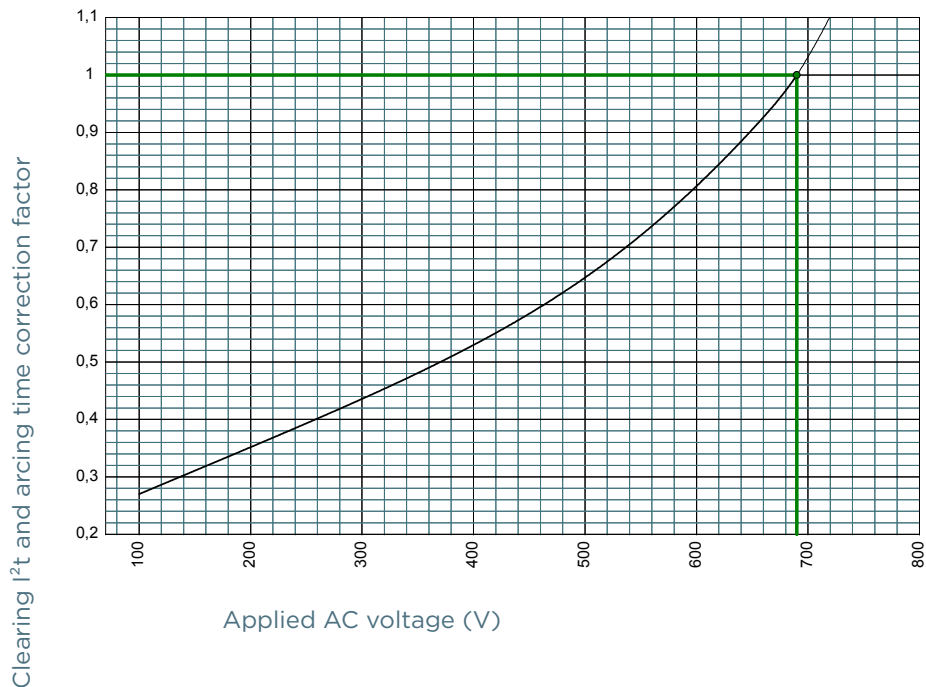

### Size 32 600V

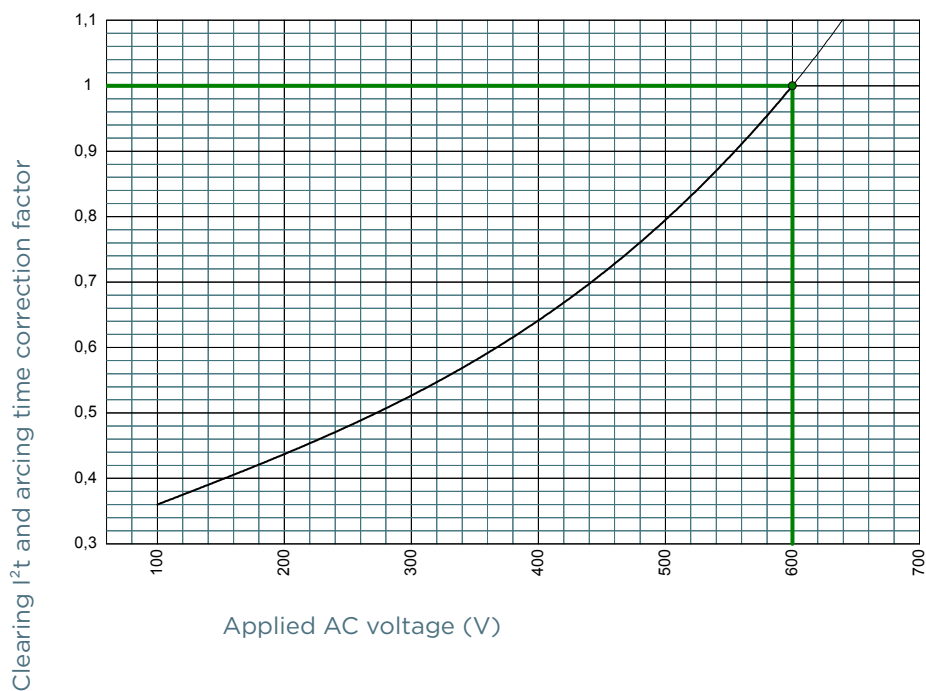

## I<sup>2</sup>T MULTIPLIER COEFFICIENT

### Size 32 550V

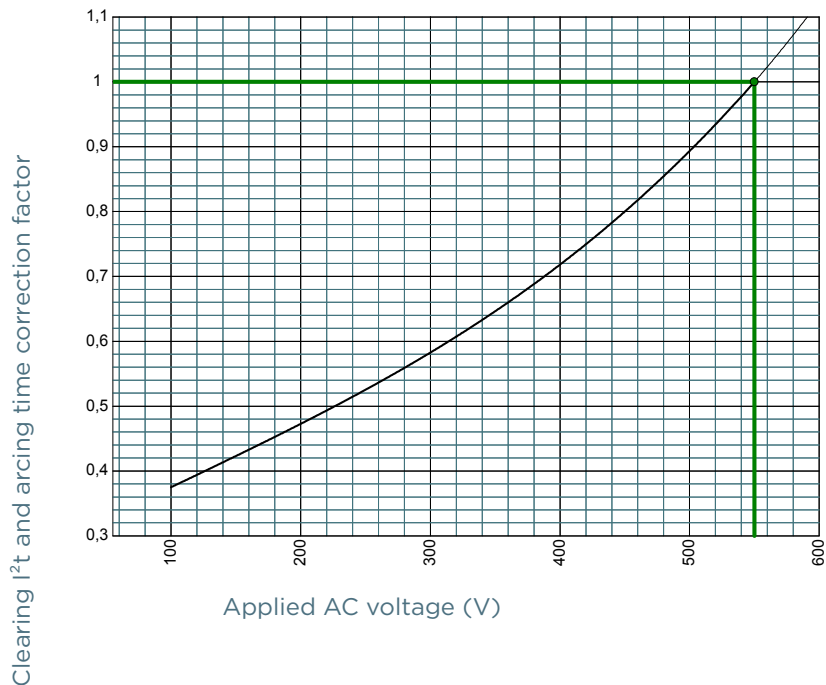

### Size 32 500V

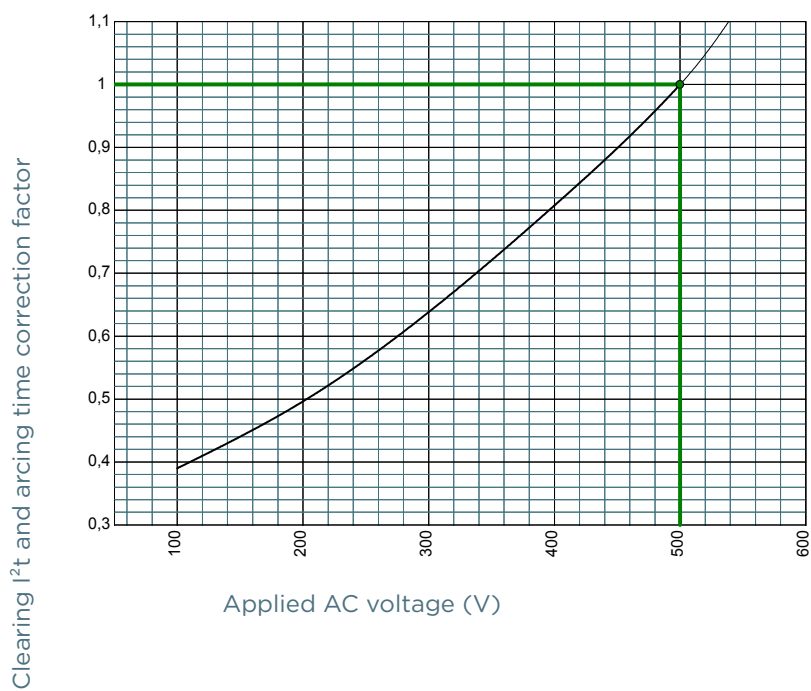

## I<sup>2</sup>T MULTIPLIER COEFFICIENT

### Size 32 450V

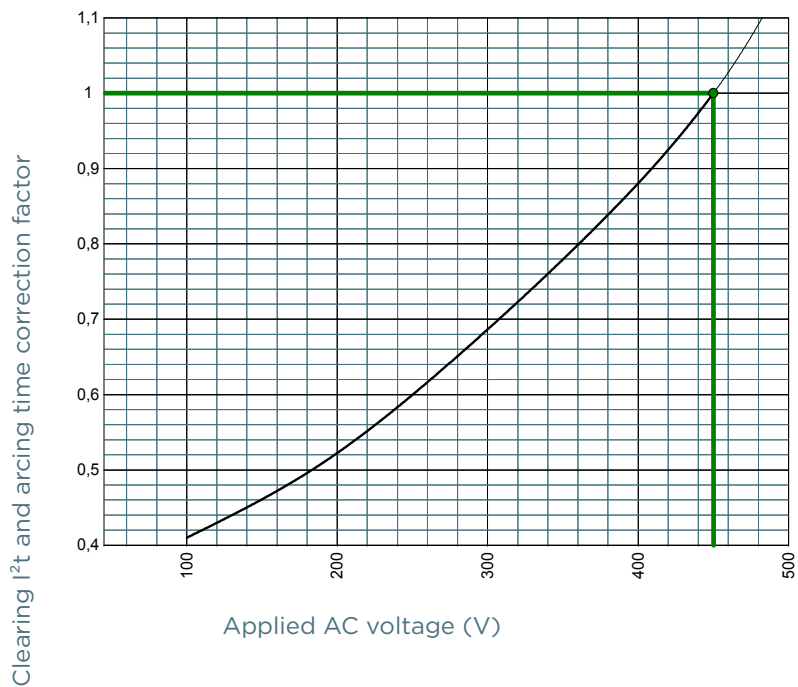

CHARACTERISTICS TOTAL I<sup>2</sup>T CURVE

Size 32 690V

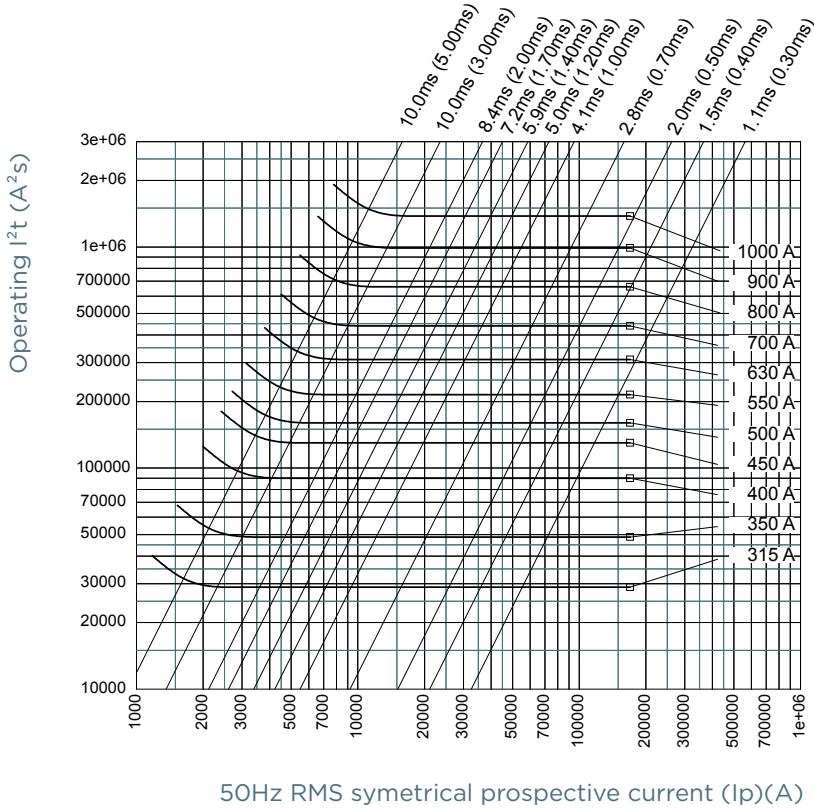

Size 32 660V

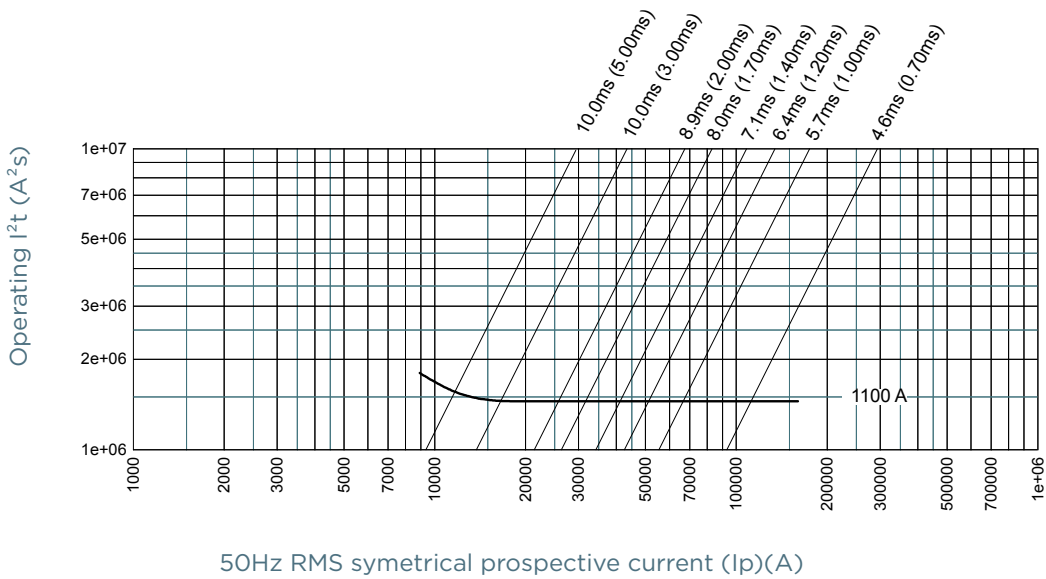

MERSEN reserves the right to change, update or correct, without notice, any information contained in this datasheet.

CHARACTERISTICS TOTAL I<sup>2</sup>T CURVE

Size 32 550V

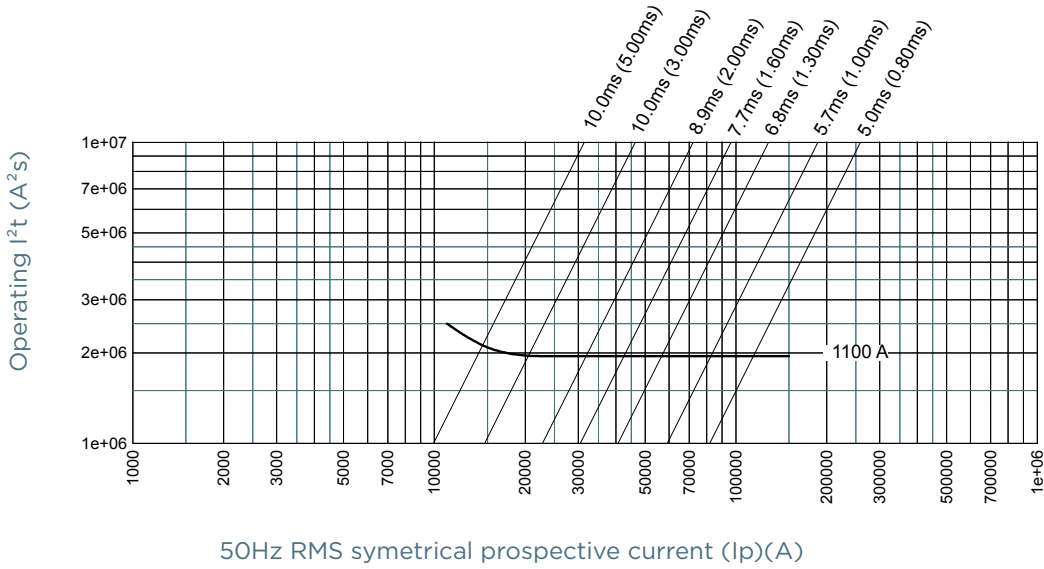

Size 32 500V

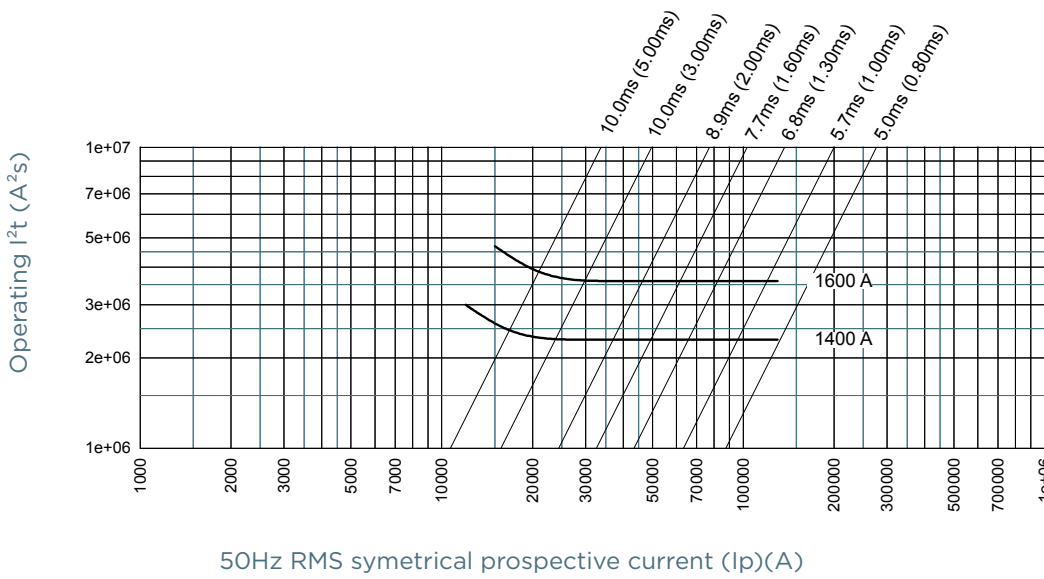

MERSEN reserves the right to change, update or correct, without notice, any information contained in this datasheet.

CHARACTERISTICS TOTAL I<sup>2</sup>T CURVE

Size 32 450V

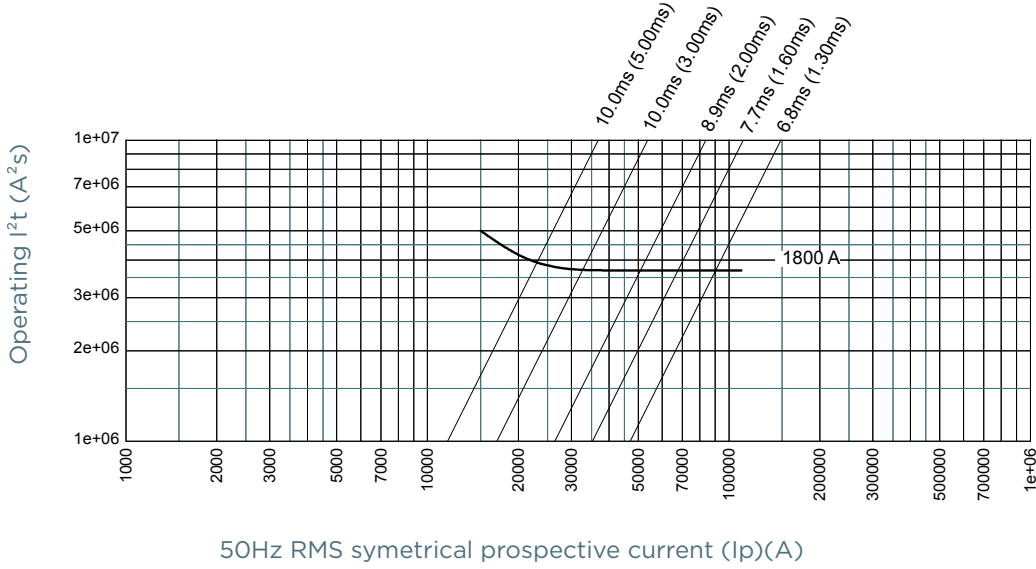

POWER DISSIPATION

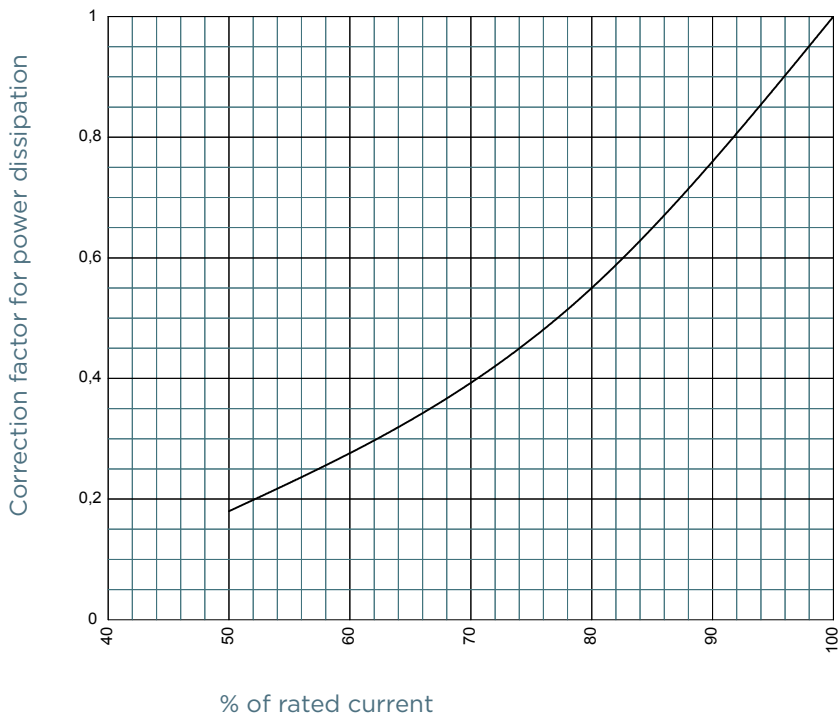

MERSEN reserves the right to change, update or correct, without notice, any information contained in this datasheet.

## PEAK ARC VOLTAGE

### Size 32 690V

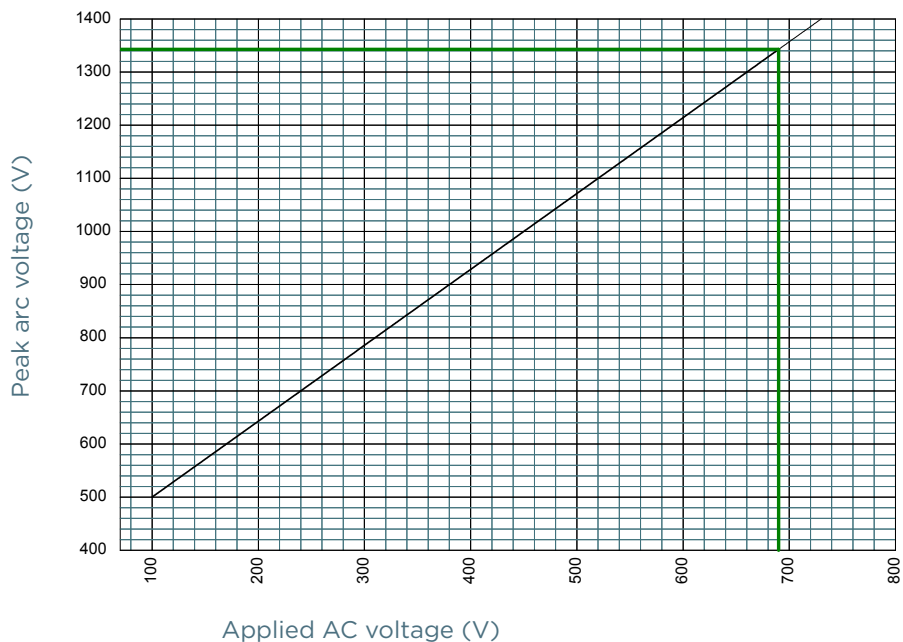

### Size 32 600V

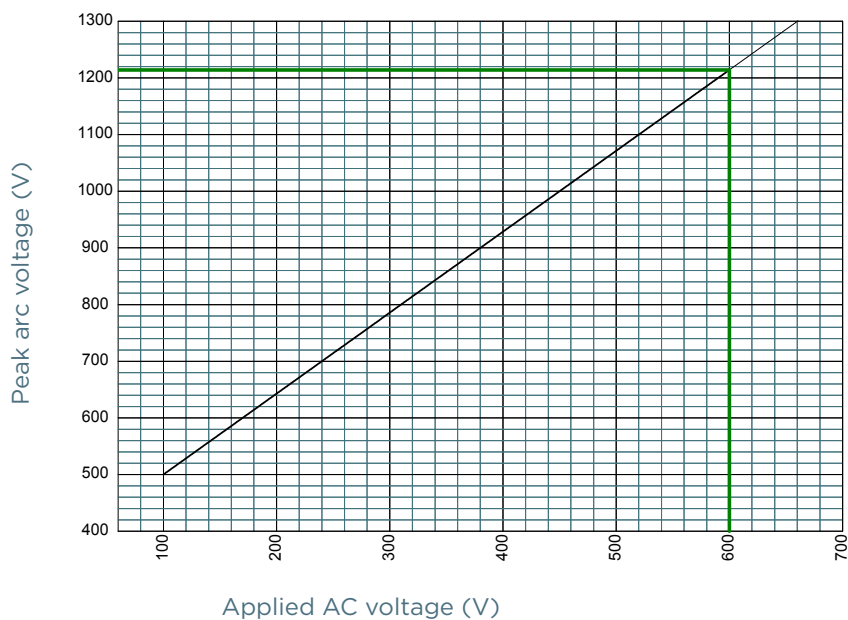



## PEAK ARC VOLTAGE

### Size 32 550V

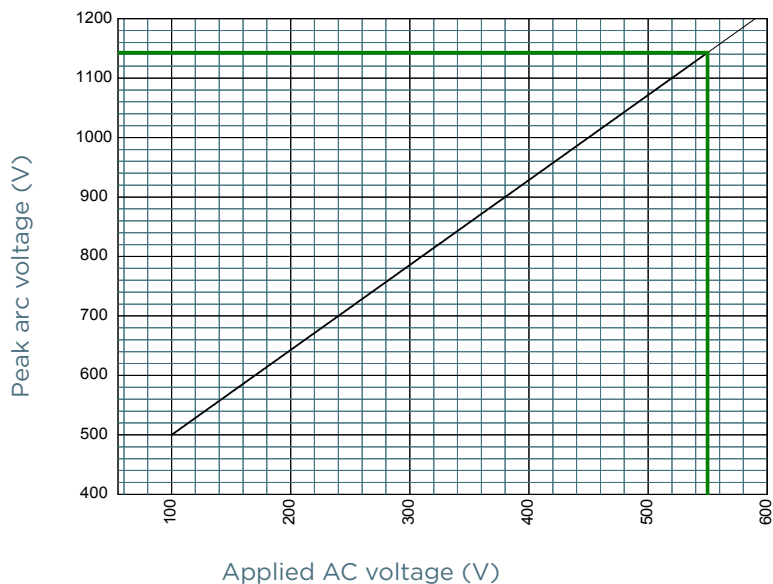

### Size 32 500V

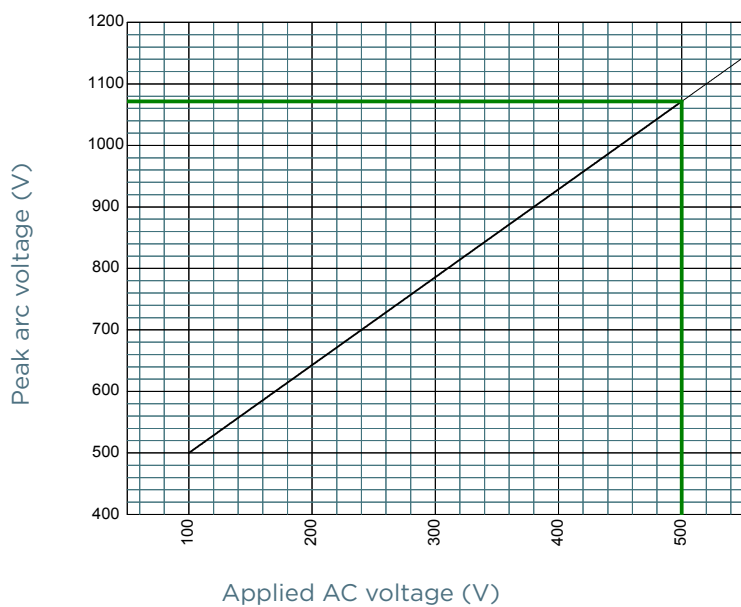

## PEAK ARC VOLTAGE

### Size 32 450V

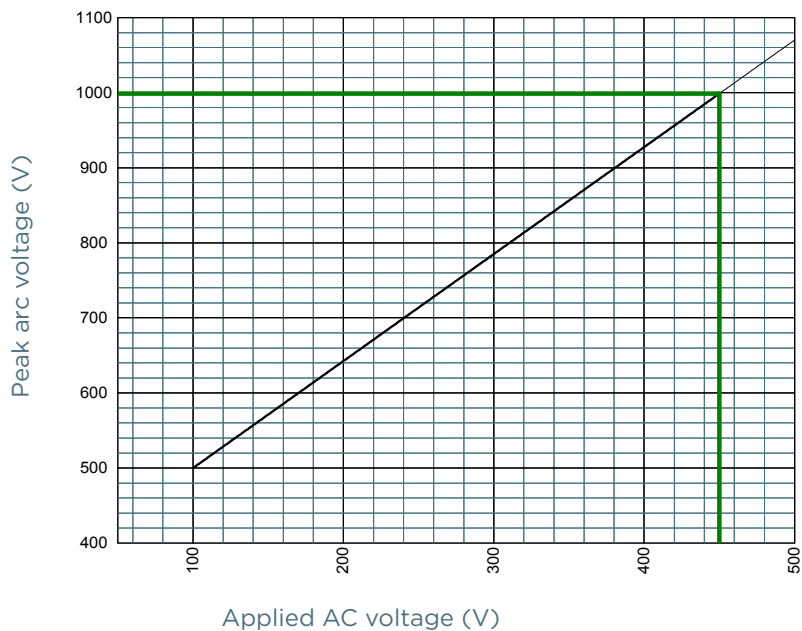

# Protistor® size 32 aR

450 to 690VAC (IEC) / 700VAC (UL)

## DIMENSIONS

Size 32 type DIN 80 (102923)

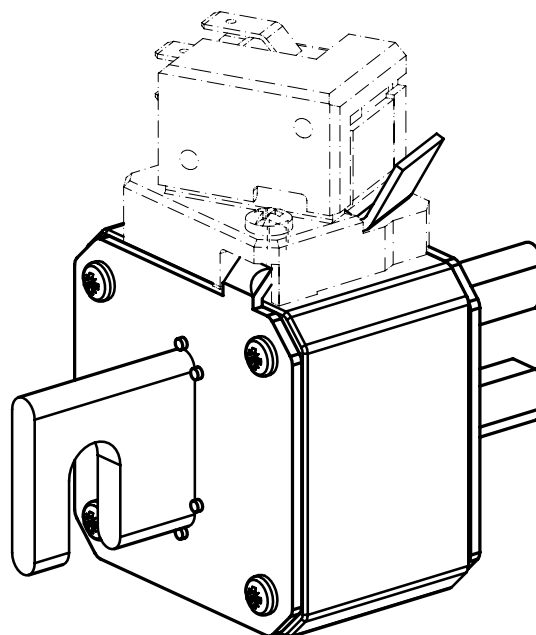
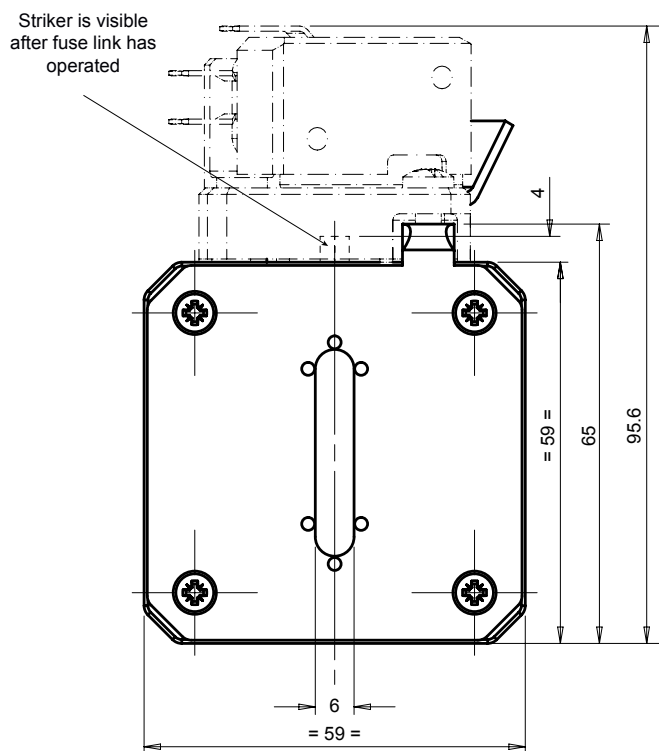
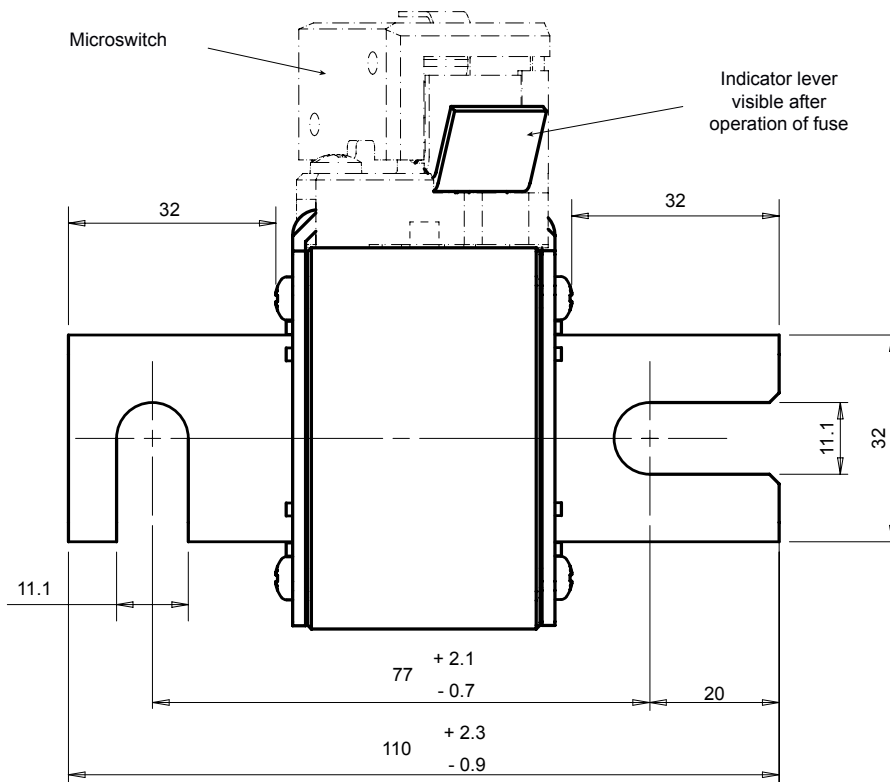

Dimensions in mm

# Protistor® size 32 aR

450 to 690VAC (IEC) / 700VAC (UL)

## DIMENSIONS

Size 32 type DIN 110 (102922)

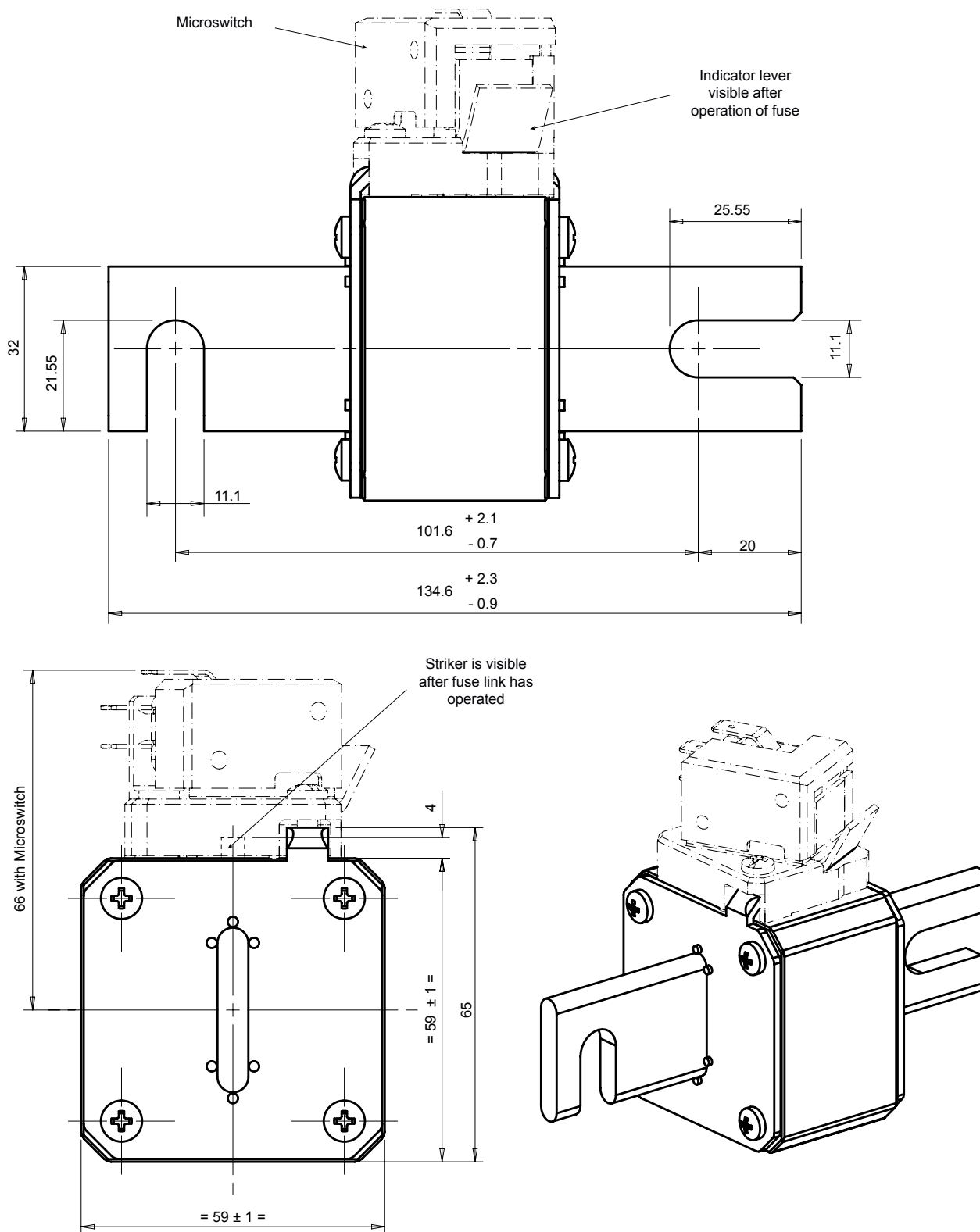

MERSEN reserves the right to change, update or correct, without notice, any information contained in this datasheet.

# Protistor® size 32 aR

450 to 690VAC (IEC) / 700VAC (UL)

## DIMENSIONS

Size 32 type TTF (102756)

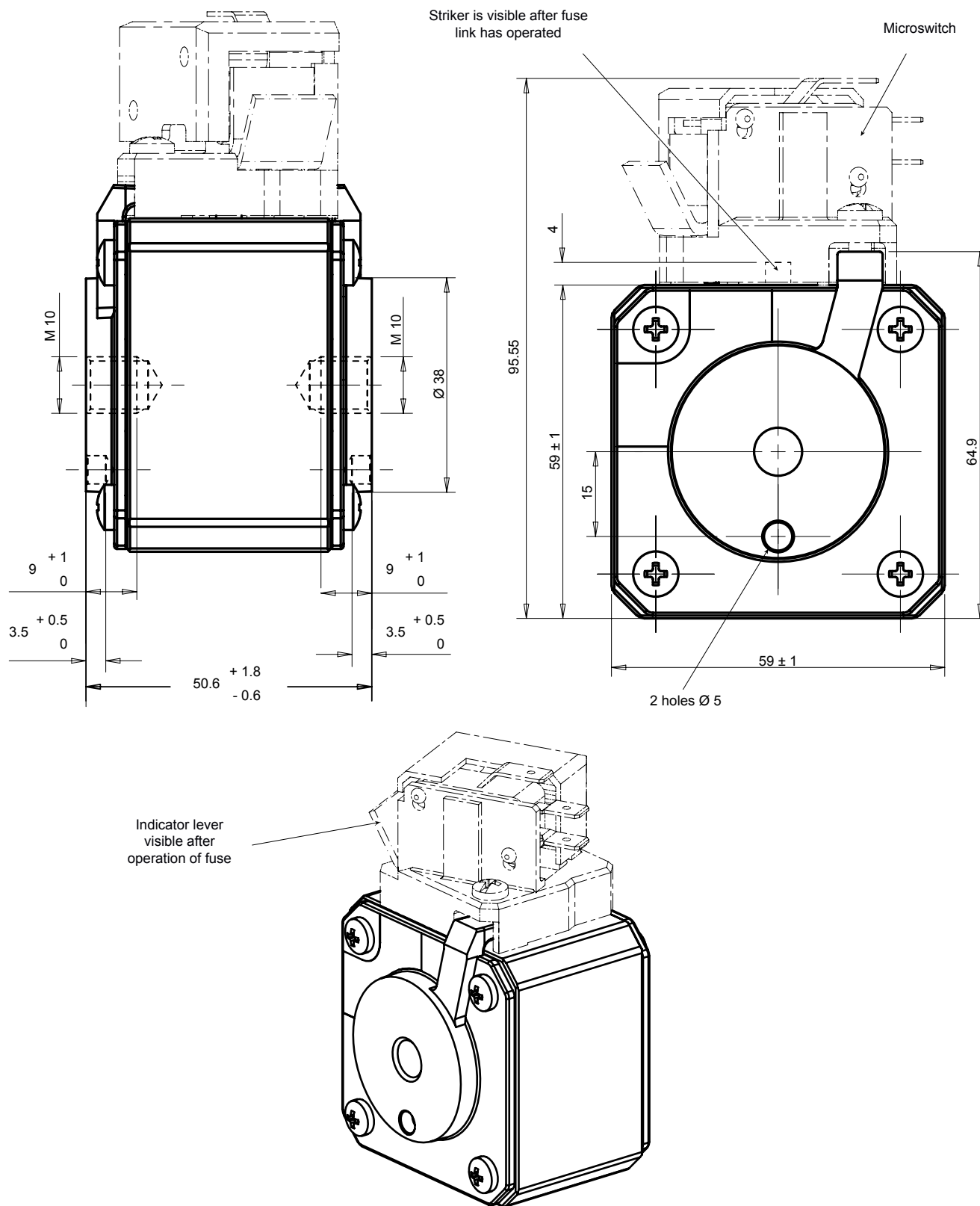

Dimensions in mm

# Protistor® size 32 aR

450 to 690VAC (IEC) / 700VAC (UL)

## DIMENSIONS

Size 32 type TTF reinforced (108188)

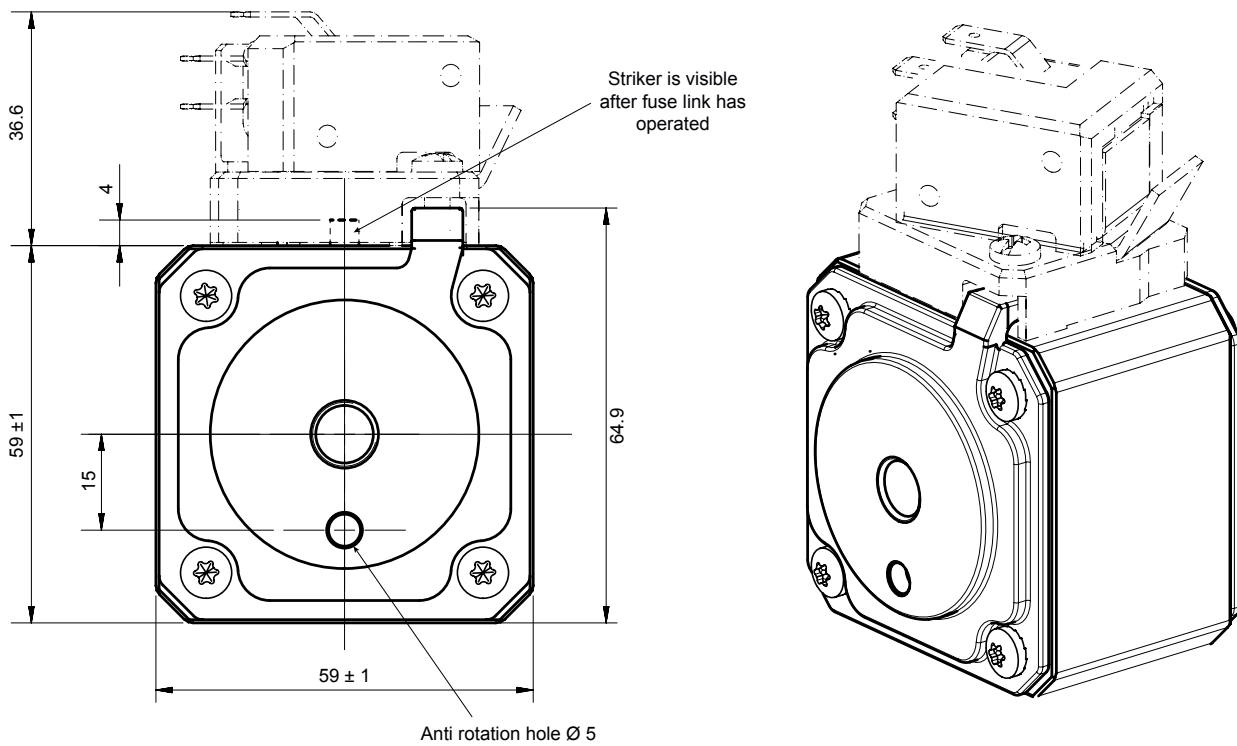
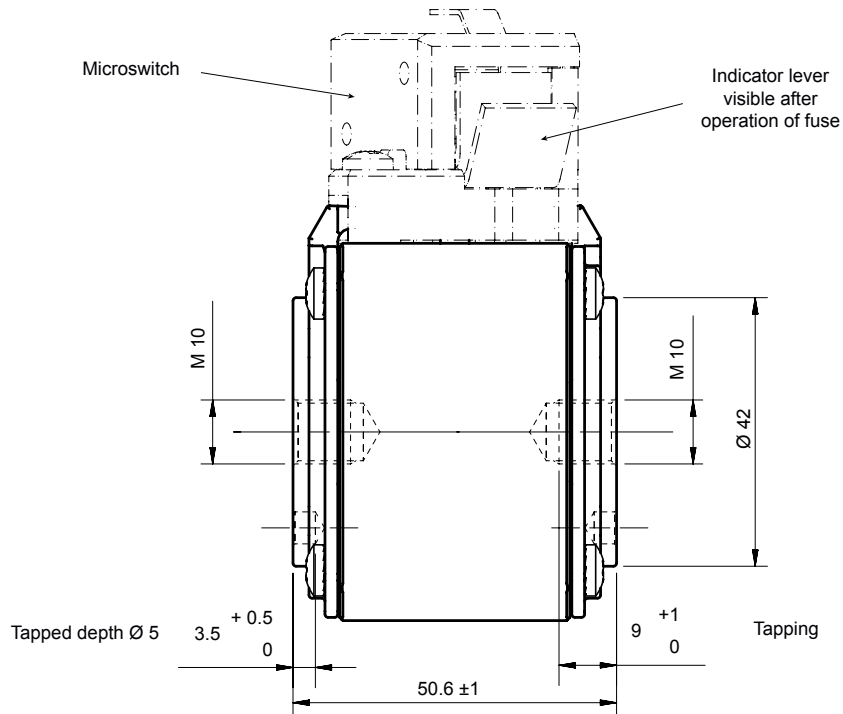

Dimensions in mm

# Protistor® size 32 aR

450 to 690VAC (IEC) / 700VAC (UL)

## DIMENSIONS

Size 32 type KI (102925)

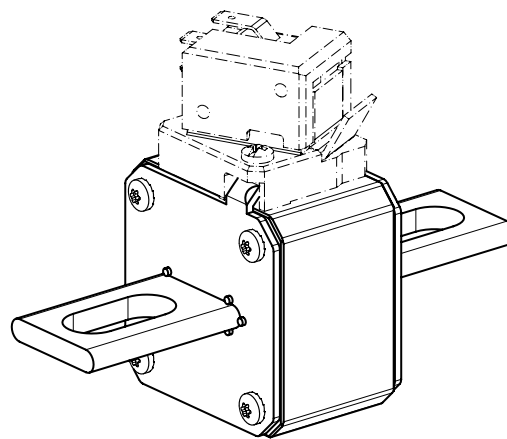
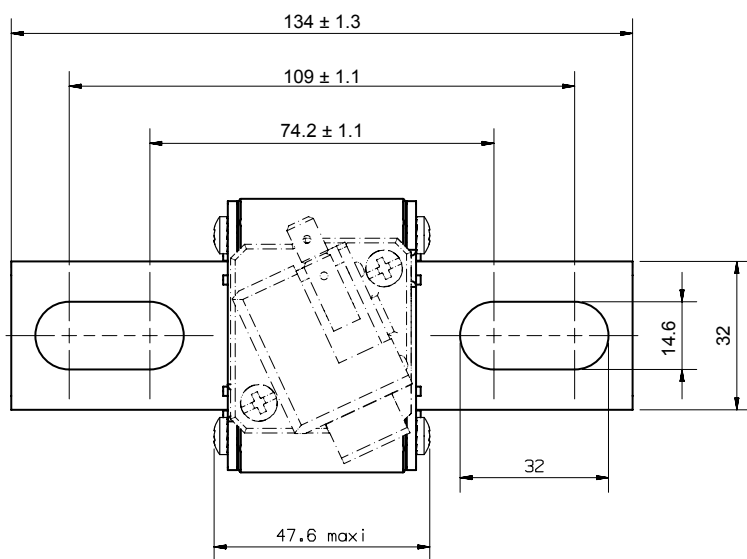
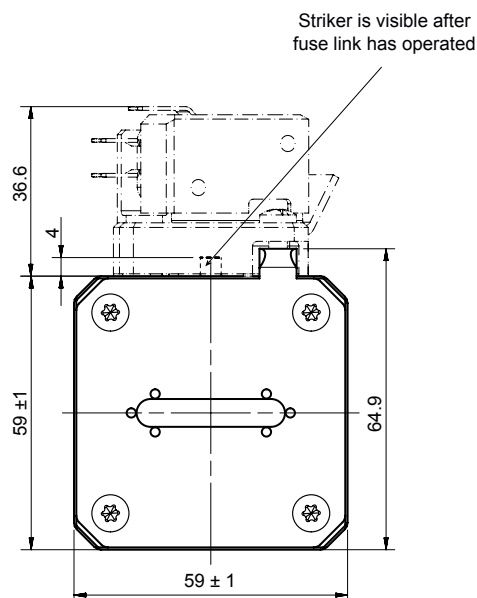
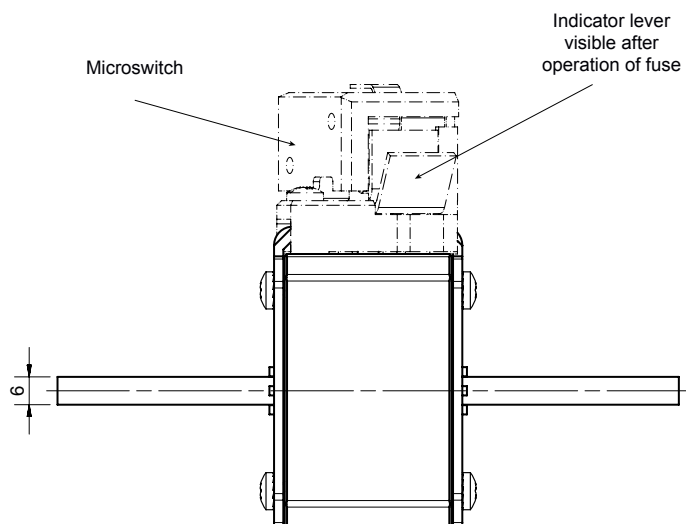

Dimensions in mm

MERSEN reserves the right to change, update or correct, without notice, any information contained in this datasheet.

# Protistor® size 32 aR

450 to 690VAC (IEC) / 700VAC (UL)

## DIMENSIONS

Size 32 type LI (102926)

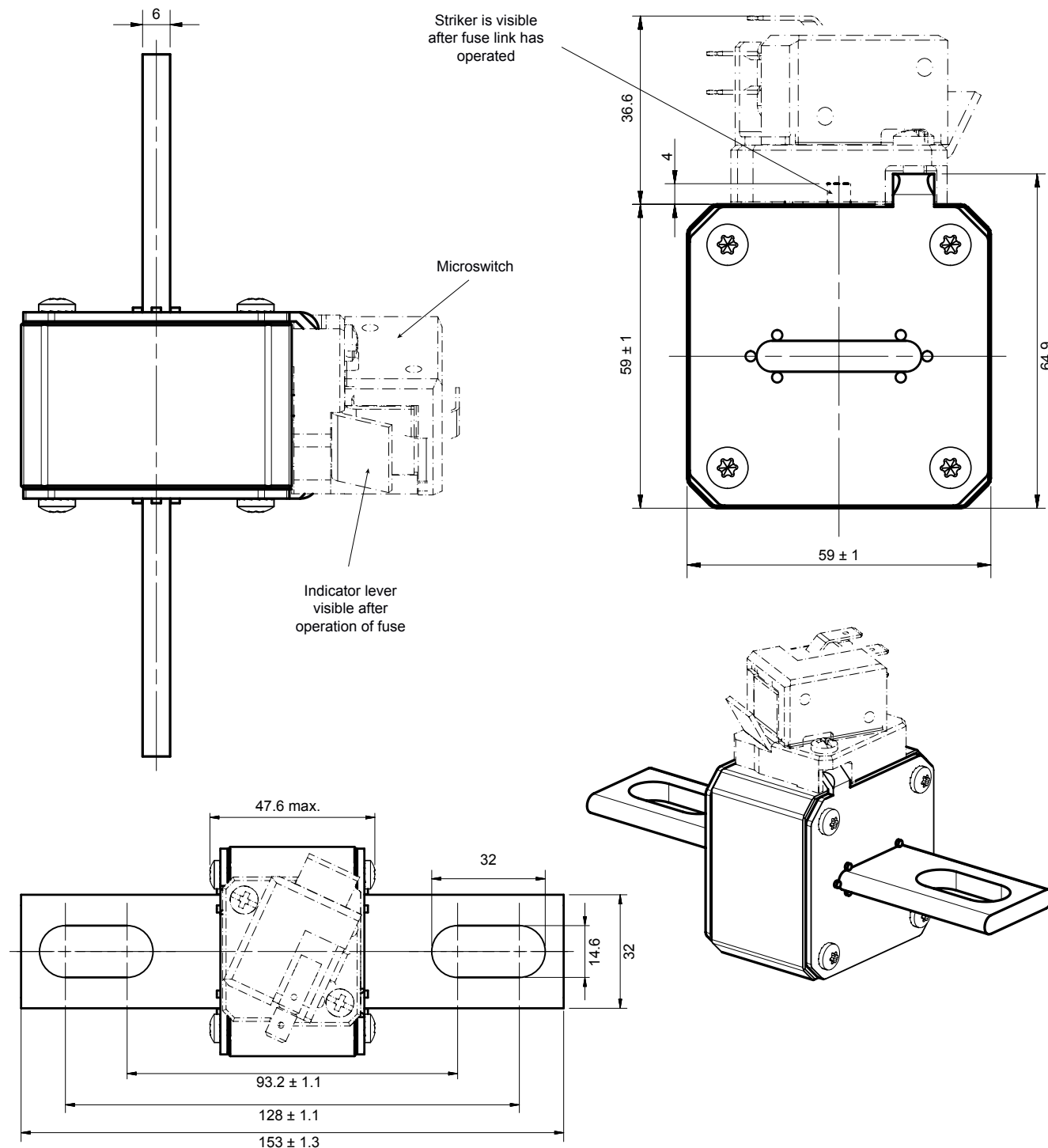

Dimensions in mm



# Protistor® size 32 aR

450 to 690VAC (IEC) / 700VAC (UL)

## DIMENSIONS

Size 32 type TTI (107302)

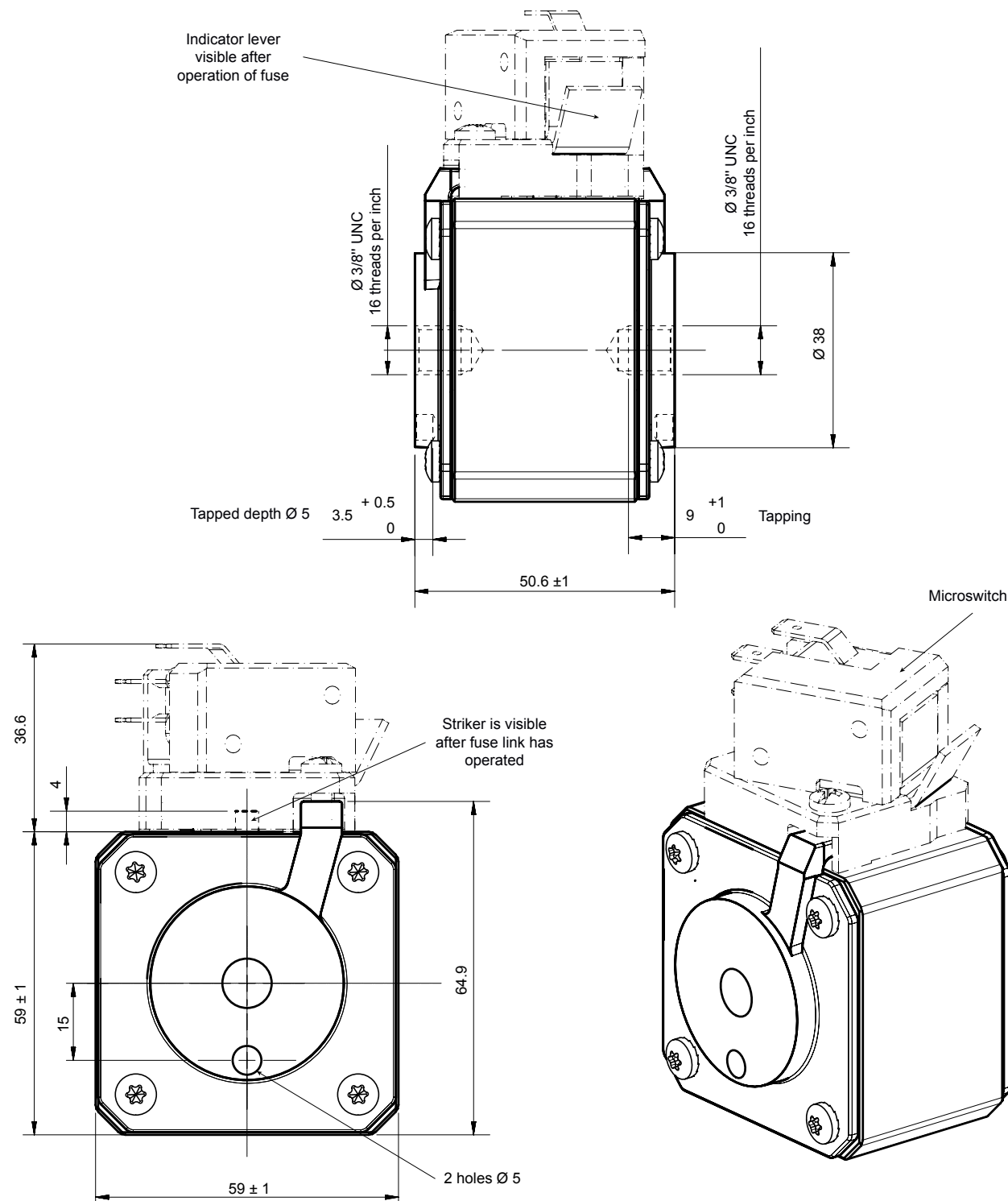

Dimensions in mm

# Protistor® size 32 aR

450 to 690VAC (IEC) / 700VAC (UL)

## DIMENSIONS

Size 32 type TTI reinforced (108833)

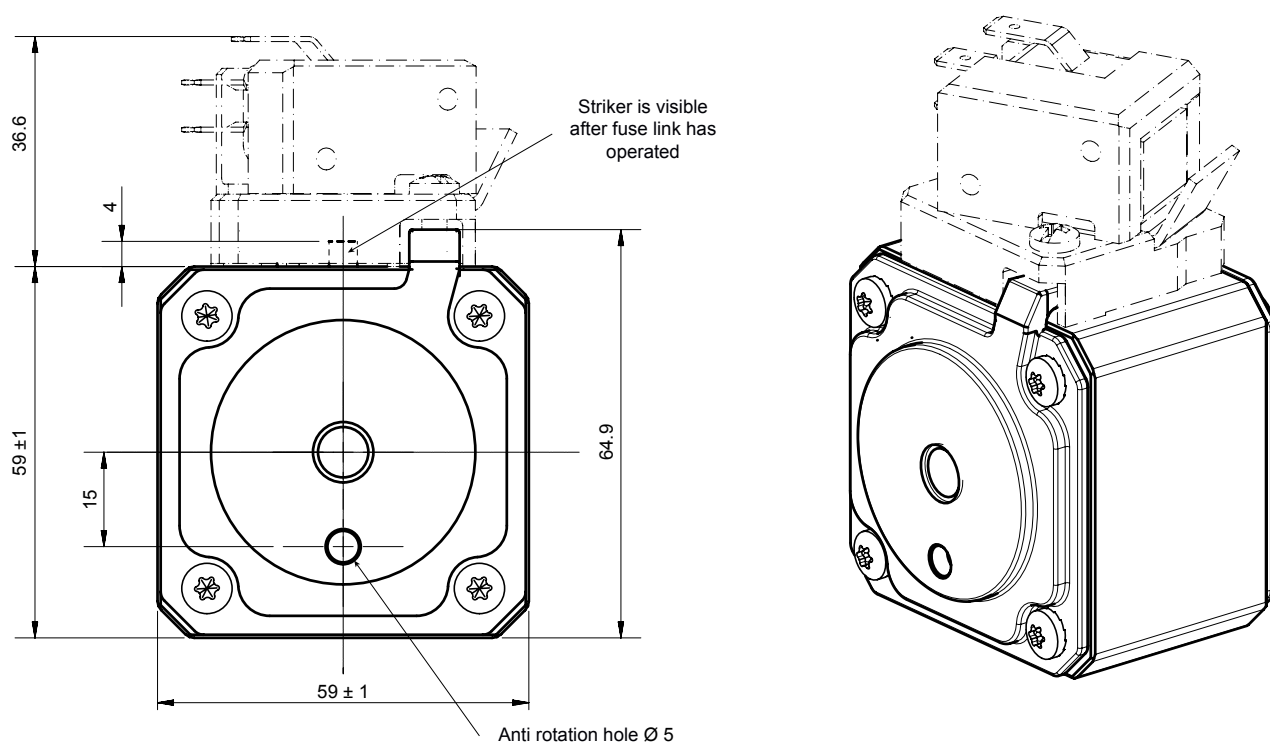
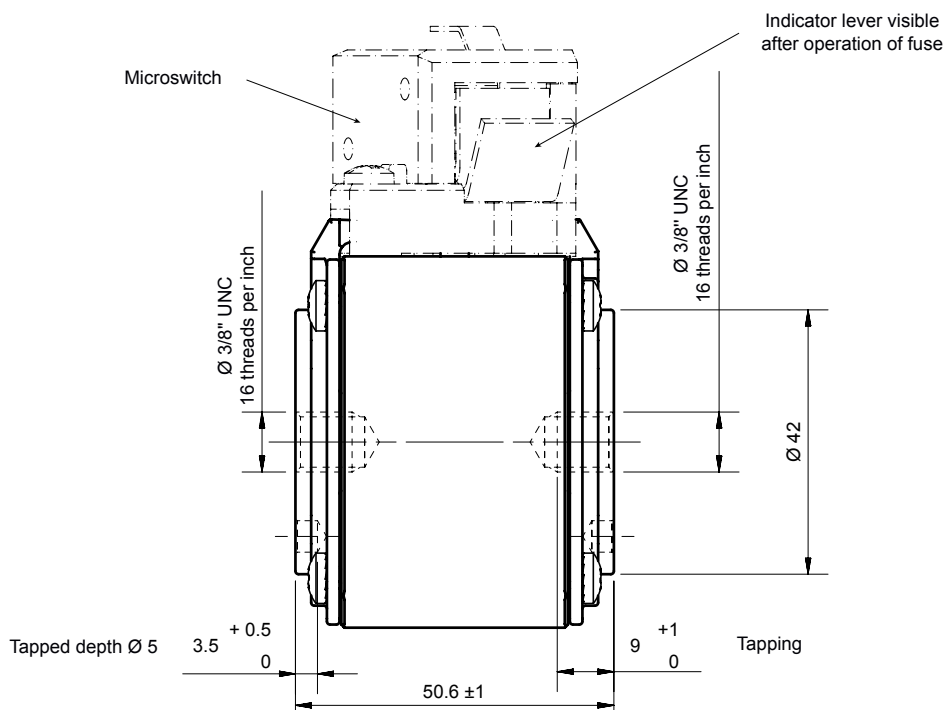

Dimensions in mm

MERSEN reserves the right to change, update or correct, without notice, any information contained in this datasheet.

# Protistor® size 32 aR

450 to 690VAC (IEC) / 700VAC (UL)

## DIMENSIONS

Size 32 type EF (102924)

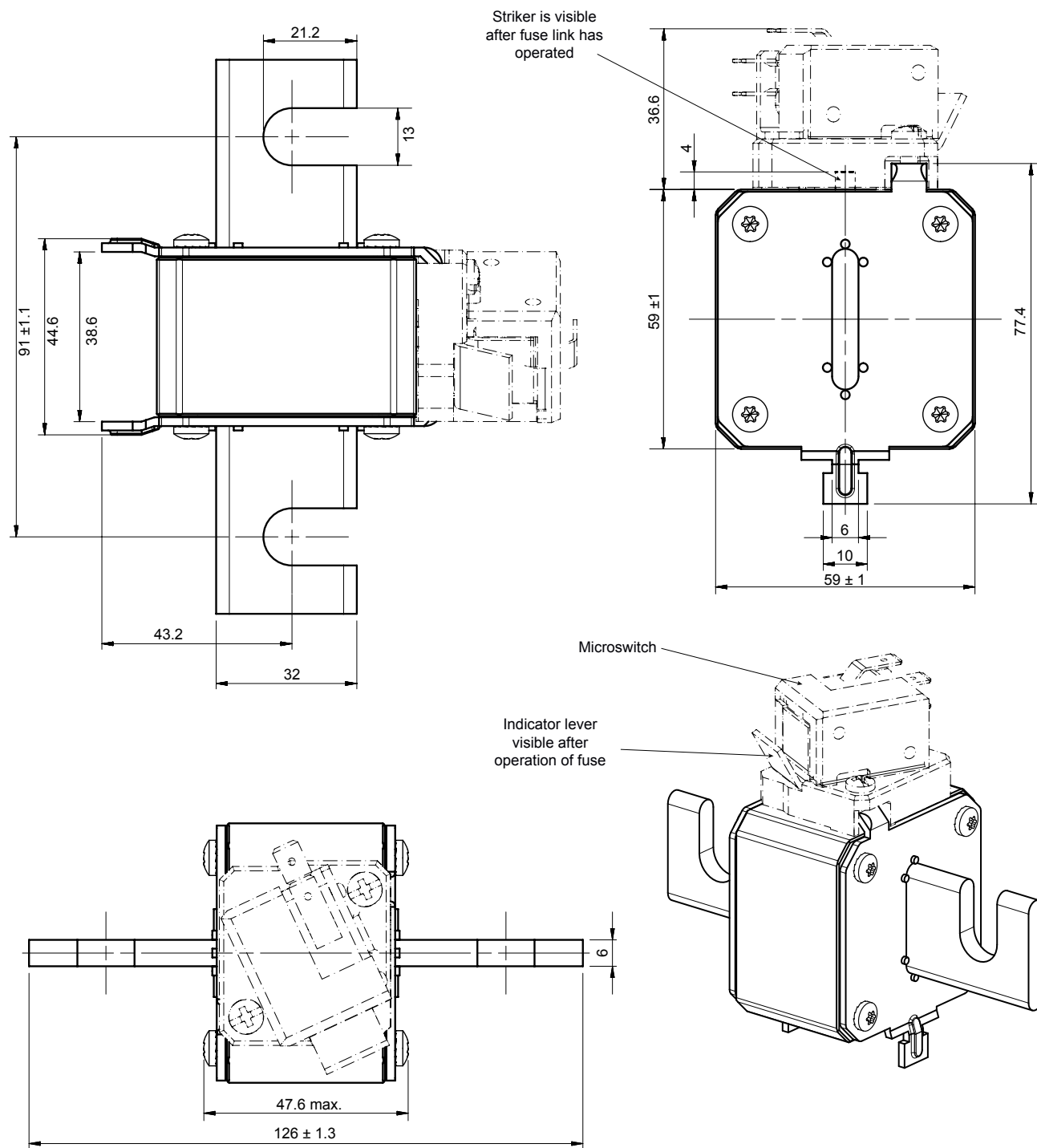

Dimensions in mm